

# LIFTBOAT

## Specifications

### DIMENSIONS

Overall Length	70'
Overall Beam	34'
Beam' (Hull Only)	30'
Hull Depth	6' - 7'

### Characteristics

Open Deck	1,500 sq. ft
Maximum Deck Capacity (Afloat)	100,000 lbs.
Maximum Deck Capacity (Elevated)	120,000 lbs.
Deck Strength (max, point load)	750 lbs./sq. ft.

### LEGS

Quantity	3
Length	105'
Diameter	30" O.D.
Wall Thickness	1/2"

### PADS

Length	21'
Width	7'
Depth	32"

### CRANES

Quantity	2
Capacity of Port Crane	30 Tons
Boom Length	70' Telescopic
Capacity of Crane #2	15 Tons
Boom Length	70' Telescopic

### GENERATORS

Two (2)	30KW
---------	------

### GROSS TONNAGE

Under 100

### Living Quarters

Berths	16 + (4 Crew)
Central Air and Heat	
Heads	2
Showers	3
Galley Seals	8
Refrigerators	2
Freezers	1
Ice Maker	Yes
Range	Yes
Washer & Dryer	Yes

### COMMUNICATION/NAVIGATION

VHF Radio	Yes
GPS	Yes
Radar	Yes

### PROPULSION

Estimated Speed (knots)	GM. V8-92
Main Engines	8.0

### WORKING CONDITIONS

Maximum Water Depth	63'
Maximum Jacking Sens	5'

### CAPACITIES

Fuel	2,000 Gal.
Potable Water	4,000 Gal.

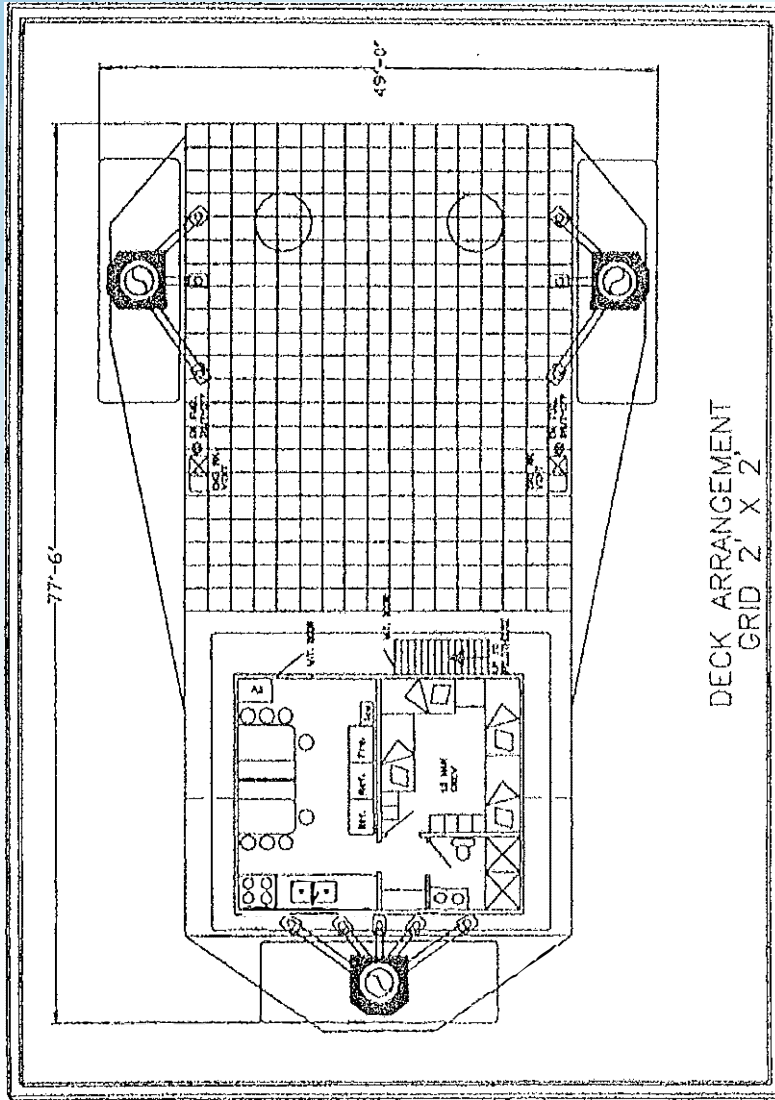

# EBI<sup>®</sup> CRANES

## MODEL TC30-40-70 TELESCOPIC BOOM CRANES (U.S. CUSTOMARY UNITS)

MODEL TC30-40-70 API LOAD CHART 40 FT. RETRACTED								BASIC CRANE WEIGHT: 28,478 LBS.	
REACH (FT.)	BOOM ANGLE (DEG.)	OFFBOARD LOAD (LBS.)	ONBOARD LOAD (LBS.)	REACH (FT.)	BOOM ANGLE (DEG.)	OFFBOARD LOAD (LBS.)	ONBOARD LOAD (LBS.)	API PEDESTAL REACTIONS (REACTIONS @ 3 X OFFBOARD RATED LOAD) (REACT. @ 1.5 X ONBOARD RATED LOAD)	
10	75.5	34900	53050	30	43.0	13650	21175	MAXIMUM OTM	= 1,625,000 FT. LBS.
15	68.5	25550	39025	35	31.0	11200	17500	CORRESPONDING AXIAL FORCE	= 64,275 LBS.
20	60.0	19850	30475	40	0.0	6650	10675	MAXIMUM AXIAL FORCE	= 137,310 LBS.
25	52.5	16400	25300					CORRESPONDING OTM	= 1,163,500 FT. LBS.

MODEL TC30-40-70 API LOAD CHART 50 FT. EXTENDED								BASIC CRANE WEIGHT: 28,478 LBS.	
REACH (FT.)	BOOM ANGLE (DEG.)	OFFBOARD LOAD (LBS.)	ONBOARD LOAD (LBS.)	REACH (FT.)	BOOM ANGLE (DEG.)	OFFBOARD LOAD (LBS.)	ONBOARD LOAD (LBS.)	API PEDESTAL REACTIONS (REACTIONS @ 3 X OFFBOARD RATED LOAD) (REACT. @ 1.5 X ONBOARD RATED LOAD)	
10	78.0	20300	20300	35	46.0	11000	17200	MAXIMUM OTM	= 1,615,500 FT. LBS.
15	72.5	20300	20300	40	37.5	9400	14800	CORRESPONDING AXIAL FORCE	= 56,400 LBS.
20	66.5	18900	20300	45	27.0	7900	12550	MAXIMUM AXIAL FORCE	= 35,160 LBS.
25	60.0	15350	20300	50	0.0	4500	7450	CORRESPONDING OTM	= 1,095,500 FT. LBS.
30	53.5	12950	20125						

MODEL TC30-40-70 API LOAD CHART 60 FT. EXTENDED								BASIC CRANE WEIGHT: 28,478 LBS.	
REACH (FT.)	BOOM ANGLE (DEG.)	OFFBOARD LOAD (LBS.)	ONBOARD LOAD (LBS.)	REACH (FT.)	BOOM ANGLE (DEG.)	OFFBOARD LOAD (LBS.)	ONBOARD LOAD (LBS.)	API PEDESTAL REACTIONS (REACTIONS @ 3 X OFFBOARD RATED LOAD) (REACT. @ 1.5 X ONBOARD RATED LOAD)	
10	80.0	20100	20100	40	48.5	8600	13600	MAXIMUM OTM	= 1,600,500 FT. LBS.
15	75.5	19850	20100	45	42.0	7700	12250	CORRESPONDING AXIAL FORCE	= 52,650 LBS.
20	70.5	16000	20100	50	34.0	6650	10675	MAXIMUM AXIAL FORCE	= 32,250 LBS.
25	65.5	13350	20100	55	25.0	5600	9100	CORRESPONDING OTM	= 1,030,500 FT. LBS.
30	60.0	11350	17725	60	0.0	2950	5125		
35	54.5	9850	15475						

MODEL TC30-40-70 API LOAD CHART 70 FT. EXTENDED								BASIC CRANE WEIGHT: 28,478 LBS.	
REACH (FT.)	BOOM ANGLE (DEG.)	OFFBOARD LOAD (LBS.)	ONBOARD LOAD (LBS.)	REACH (FT.)	BOOM ANGLE (DEG.)	OFFBOARD LOAD (LBS.)	ONBOARD LOAD (LBS.)	API PEDESTAL REACTIONS (REACTIONS @ 3 X OFFBOARD RATED LOAD) (REACT. @ 1.5 X ONBOARD RATED LOAD)	
10	81.5	20100	20100	45	50.0	5250	8275	MAXIMUM OTM	= 1,511,700 FT. LBS.
15	77.5	16850	20100	50	44.5	4600	7600	CORRESPONDING AXIAL FORCE	= 42,200 LBS.
20	73.0	12100	18850	55	38.5	4050	6775	MAXIMUM AXIAL FORCE	= 32,050 LBS.
25	69.0	10050	15775	60	31.5	3600	6100	CORRESPONDING OTM	= 650,770 FT. LBS.
30	64.5	8400	13300	65	22.5	3200	5500		
35	60.0	7100	11350	70	0.0	1800	3400		
40	55.5	6200	10000						

IN ACCORDANCE WITH API-2C, VALUES SHOWN ARE ACTUAL HOOK LOAD (WEIGHT OF BLOCK AND HOOK ENCLOSED).  
 LOAD LINE BLOCK WEIGHT IS 1200 LBS.  
 LOAD LINE (4 PART LINE): 1" X 625 EIPS IWRC; 100,000 LB. BREAKING STRENGTH; 20,000 LB. WORKING STRENGTH.  
 FAST LINE BLOCK WEIGHT IS 100 LBS.  
 FAST LINE (1 PART LINE): 3/16" X 87 EIPS IWRC; 25,000 LB. BREAKING STRENGTH; 5,000 LB. WORKING STRENGTH.  
 ONBOARD LOAD = 1.5 X OFFBOARD LOAD.  
 PEDESTAL REACTIONS ARE BASED ON THREE TIMES THE OFFBOARD LOAD PLUS DEAD LOAD.

# EBC CRANES

## MODEL TC60-43-73 TELESCOPIC BOOM CRANES (U.S. CUSTOMARY UNITS)

### MODEL TC60-43-73 API LOAD CHART 43 FT. RETRACTED

BASIC CRANE WEIGHT: 37,500 LBS.

REACH (FT.)	BOOM ANGLE (DEG.)	OFFBOARD LOAD (LBS.)	ONBOARD LOAD (LBS.)	REACH (FT.)	BOOM ANGLE (DEG.)	OFFBOARD LOAD (LBS.)	ONBOARD LOAD (LBS.)	API PEDESTAL REACTIONS (REACTIONS @ 1 X OFFBOARD RATED LOAD) (OIM - OVERTURNING MOMENT)
10	76	76300	78700	30	45	21200	32450	MAXIMUM OIM = 2,715,888 FT. LBS. CORRESPONDING AXIAL FORCE = 76,744 LBS. MAXIMUM AXIAL FORCE = 45,762 LBS. CORRESPONDING OIM = 2,775,814 FT. LBS.
15	69	47950	72575	35	35	17850	27425	
20	62	34300	52100	40	21	15100	23300	
25	54	26400	40250	43	1	13800	21350	

### MODEL TC60-43-73 API LOAD CHART 53 FT. EXTENDED

REACH (FT.)	BOOM ANGLE (DEG.)	OFFBOARD LOAD (LBS.)	ONBOARD LOAD (LBS.)	REACH (FT.)	BOOM ANGLE (DEG.)	OFFBOARD LOAD (LBS.)	ONBOARD LOAD (LBS.)	API PEDESTAL REACTIONS (REACTIONS @ 1 X OFFBOARD RATED LOAD) (OIM - OVERTURNING MOMENT)
10	79	55500	78300	35	49	17500	27000	MAXIMUM OIM = 2,485,910 FT. LBS. CORRESPONDING AXIAL FORCE = 71,772 LBS. MAXIMUM AXIAL FORCE = 47,532 LBS. CORRESPONDING OIM = 2,595,266 FT. LBS.
15	73	45500	69000	40	42	15000	23300	
20	68	33500	51000	45	32	12800	19900	
25	62	26300	40200	50	20	11000	17300	
30	56	21000	32300	53	1	10300	16200	

### MODEL TC60-43-73 API LOAD CHART 65 FT. EXTENDED

REACH (FT.)	BOOM ANGLE (DEG.)	OFFBOARD LOAD (LBS.)	ONBOARD LOAD (LBS.)	REACH (FT.)	BOOM ANGLE (DEG.)	OFFBOARD LOAD (LBS.)	ONBOARD LOAD (LBS.)	API PEDESTAL REACTIONS (REACTIONS @ 1 X OFFBOARD RATED LOAD) (OIM - OVERTURNING MOMENT)
10	81	42000	63800	40	51	14500	22900	MAXIMUM OIM = 2,573,591 FT. LBS. CORRESPONDING AXIAL FORCE = 67,271 LBS. MAXIMUM AXIAL FORCE = 40,743 LBS. CORRESPONDING OIM = 2,538,557 FT. LBS.
15	76	33000	50300	45	45	12800	19900	
20	71	27000	41300	50	38	11000	17300	
25	67	23500	34000	55	30	9800	15400	
30	62	20500	31500	60	18	8800	13900	
35	56	17300	26700	65	1	7800	12400	

### MODEL TC60-43-73 API LOAD CHART 73 FT. EXTENDED

REACH (FT.)	BOOM ANGLE (DEG.)	OFFBOARD LOAD (LBS.)	ONBOARD LOAD (LBS.)	REACH (FT.)	BOOM ANGLE (DEG.)	OFFBOARD LOAD (LBS.)	ONBOARD LOAD (LBS.)	API PEDESTAL REACTIONS (REACTIONS @ 1 X OFFBOARD RATED LOAD) (OIM - OVERTURNING MOMENT)
10	82	39000	59300	45	52	11800	18400	MAXIMUM OIM = 2,585,854 FT. LBS. CORRESPONDING AXIAL FORCE = 61,371 LBS. MAXIMUM AXIAL FORCE = 45,369 LBS. CORRESPONDING OIM = 2,417,061 FT. LBS.
15	78	28500	43500	50	47	10700	16700	
20	74	23500	36000	55	41	9500	15000	
25	70	19900	30600	60	35	8800	13900	
30	66	17300	26700	65	27	8000	12800	
35	61	14800	22900	70	17	7000	11300	
40	57	13300	20700	73	1	6800	10900	

IN ACCORDANCE WITH API-2C, VALUES SHOWN ARE ACTUAL HOOK LOAD (WEIGHT OF BLOCK AND HOOK EXCLUDED).

LOAD LINE BLOCK WEIGHT IS 1300 LBS.

LOAD LINE (4 PART LINE): 1" 6X25 EIPS IWRC; 100,000 LB. BREAKING STRENGTH; 20,000 LB. WORKING STRENGTH.

FAST LINE BLOCK WEIGHT IS 110 LBS.

FAST LINE (1 PART LINE): 3/16" 19X7 EIPS IWRC; 150,000 LB. BREAKING STRENGTH; 5,000 LB. WORKING STRENGTH.

ONBOARD LOAD = 1.5 X OFFBOARD LOAD.

PEDESTAL REACTIONS ARE BASED ON THREE TIMES THE OFFBOARD LOAD PLUS DEAD LOAD.

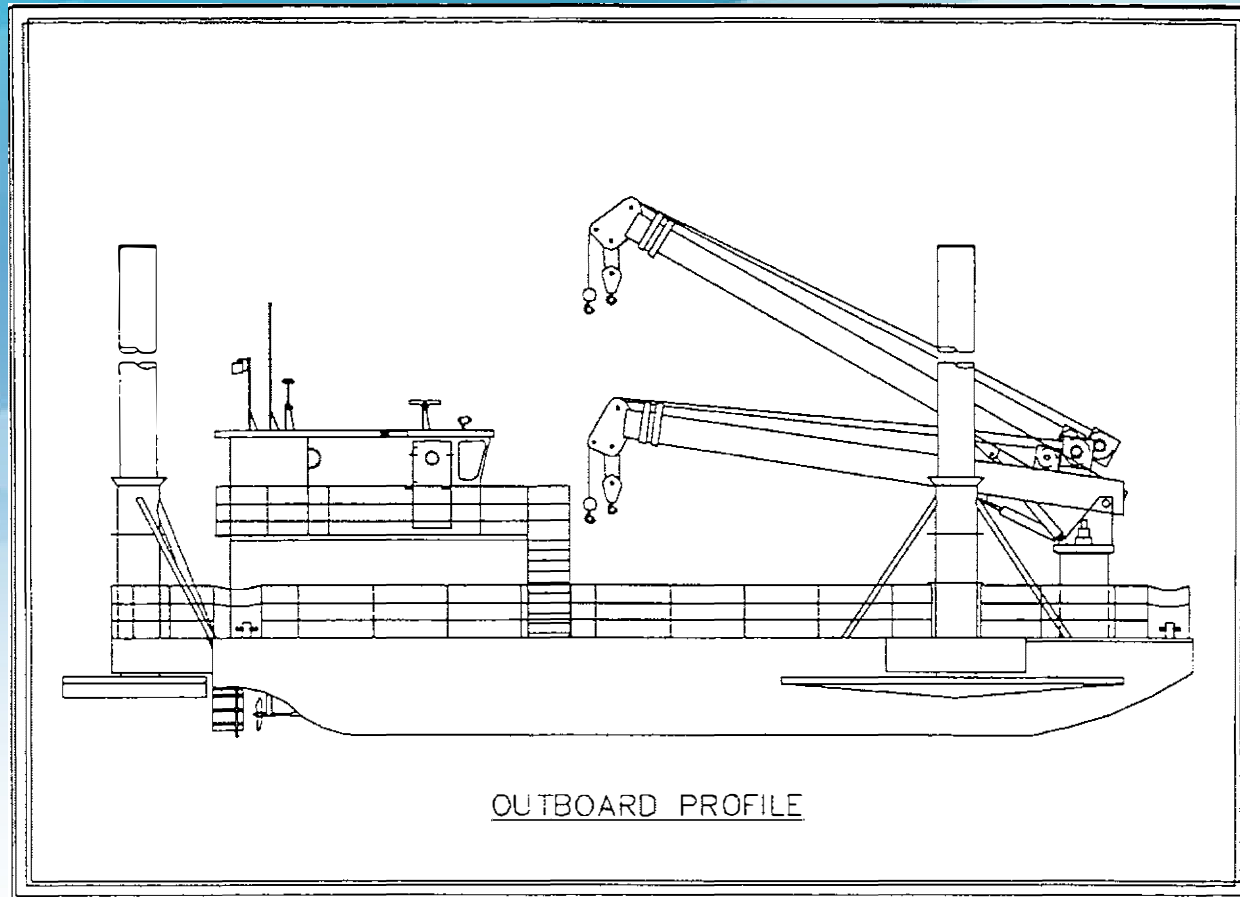

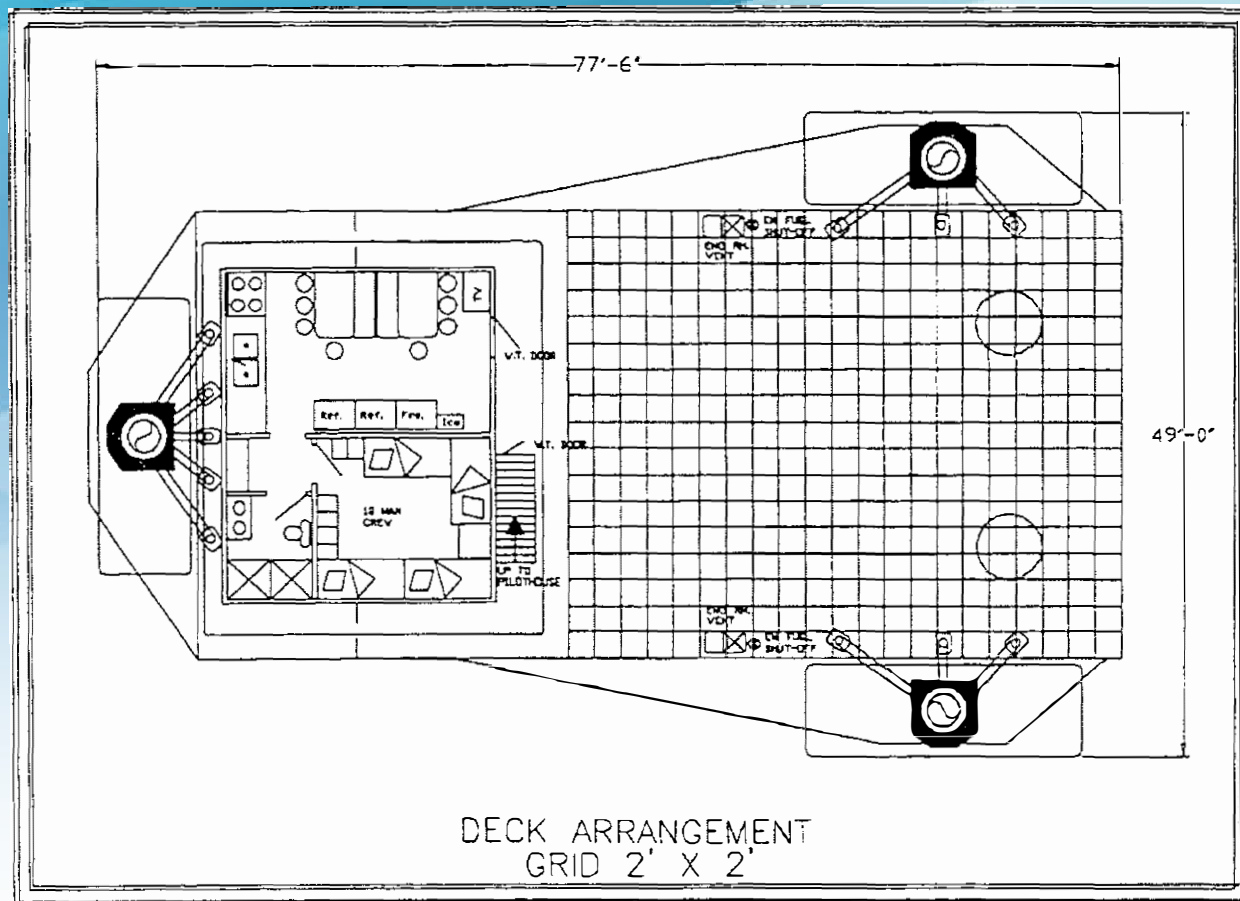

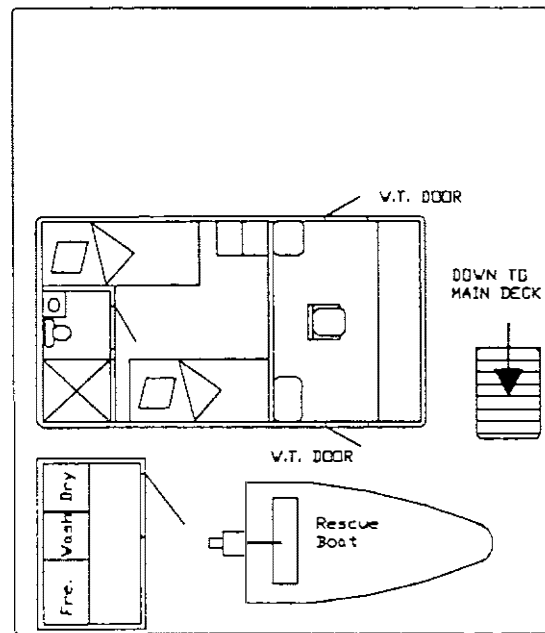

PILOT HOUSE ARRANGEMENT