

42 m CREWBOAT



Specifications

MAIN PARTICULARS

LENGTH OVERALL	140.0 ft.	42.67 m
BEAM (HULL)	26.0 ft.	7.92 m
DEPTH	12.0 ft.	3.66 m
DRAFT (LIGHT)	7.0 ft.	2.13 m
DRAFT (MAX.)	9.0 ft.	2.74 m

CONSTRUCTION

HULL	ALUMINUM
SUPERSTRUCTURE	ALUMINUM

PERFORMANCE

SPEED	23 KTS in Economical Mode/ Max 30 KTS
FUEL CONSUMPTION	140 GPH

DECK CARGO

BOARDED DECK LENGTH	77 ft.	23.47 m
BOARDED DECK WIDTH	24 ft.	7.32 m
BOARDED DECK AREA	1,848 sq.ft.	171.68 m ²
DECK CAPACITY	135 LT	137.17 MT

TRANSFER WATER/FUEL

TRANSFERABLE POTABLE	17,700 USG	67.00 m ³
WATER SHIP/TRANSFERABLE	4,300 USG	16.28 m ³
FUEL TRANSFERABLE FUEL	5,500 USG	20.82 m ³

TRANSFER RATES

FUEL	175 GPM	0.80 m ³ /min.
POTABLE WATER	175 GPM	0.80 m ³ /min.

ACCOMMODATIONS

PASSENGERS	67
STATEROOMS	(2) SINGLE, (1) DOUBLE, (1) 4-MAN
BUNKS	(4) CREW (4) PASSENGER (8) TOTAL
HEADS	2
SHOWER	1
GALLEY SEATING	9
AIR CONDITIONING/ HEATING	2/1

MACHINERY

TOTAL HORSEPOWER	3,300 HP
MAIN ENGINES	(4) CAT 3412 DITTA 7BL @ 825 HP
GEARS GENERATORS	(4) TWIN DISC 5202, RATIO 2.5:1
FIRE MONITOR	(2) GM 371/DELCO 40 KW 1,000 GPM @ 1800 RPM

ELECTRONICS

VHF	2
SSB	1
RADAR	2
GPS CHART PLOTTER	1
FATHOMETER	1
AIS SYSTEM	1
WEATHER FAX	1
STARLINK	1
SECURITY CAMERA SYSTEM	1
SPOTLIGHTS	2
DECKLIGHTS	2

DOCUMENTATION - CERTIFICATION

YEAR BUILT	1994
BUILDER	BREAUX BAY CRAFT
HULL NUMBER	TBD
OFFICIAL #	TBD
TONNAGE - GROSS	90
TONNAGE - NET	61
HOME PORT FLAG	MORGAN CITY, LA
CLASSIFICATION	USA
ROUTE	USCG CERTIFIED, SUBCHAPTER T US GOM 200 NM
OTHER	CERTIFIED TO CARRY AVIATION FUEL

SAFETY

INFLATABLE LIFT RAFTS	2
LIFE JACKETS	75
EPIRB	1
RESCUE PLATFORM	1
LIFE RINGS	3

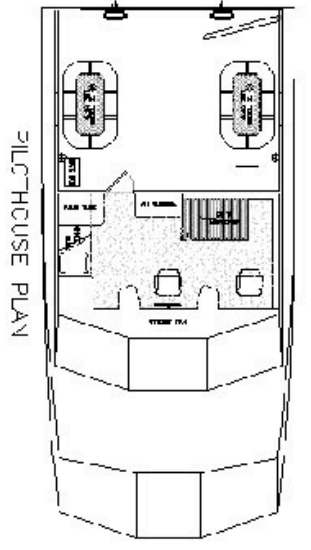

OUTBOARD PROFILE

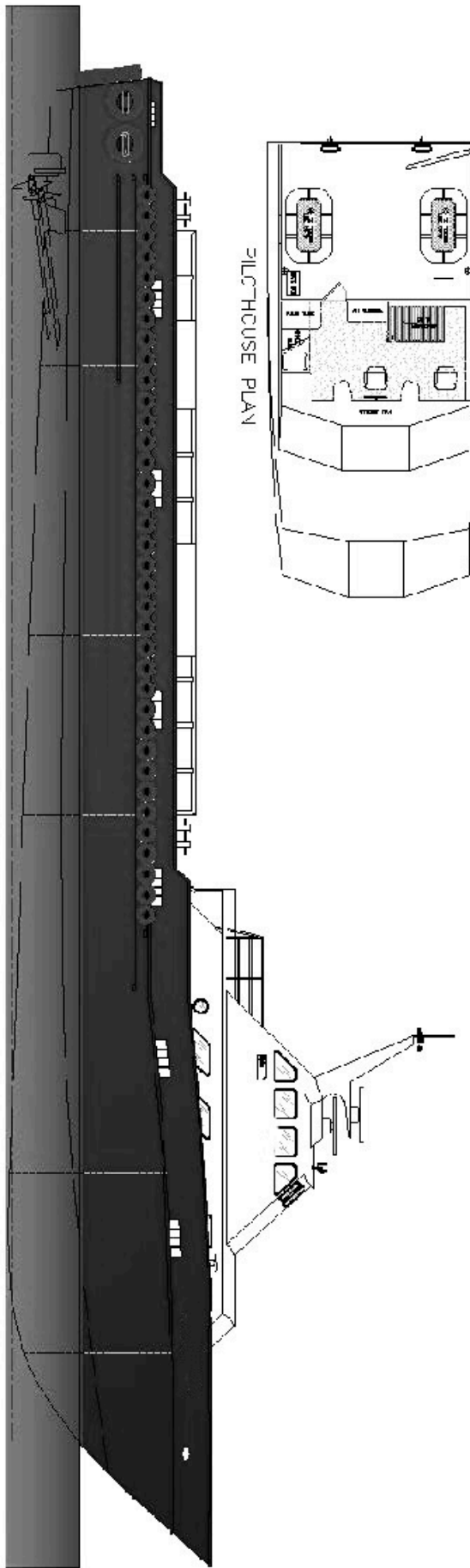

MAIN DECK PLAN

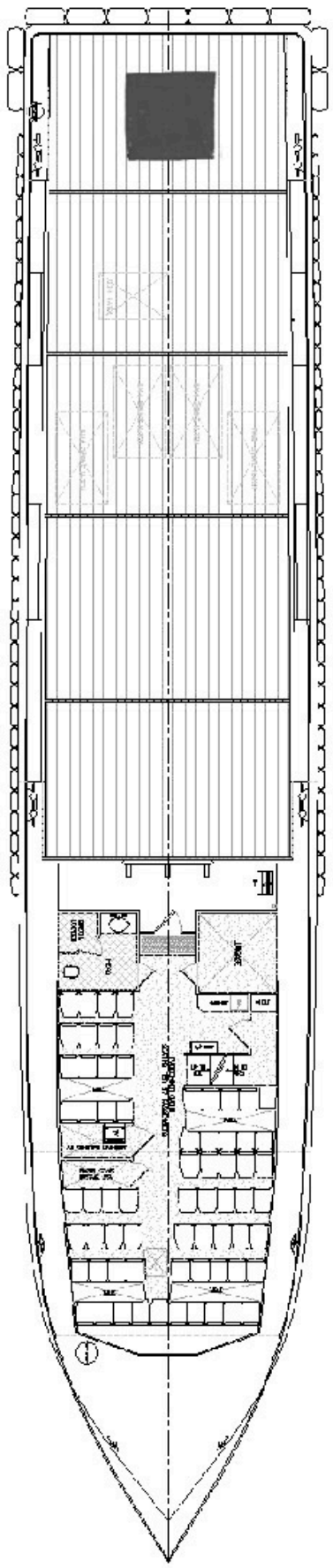

BELOW DECK PLAN

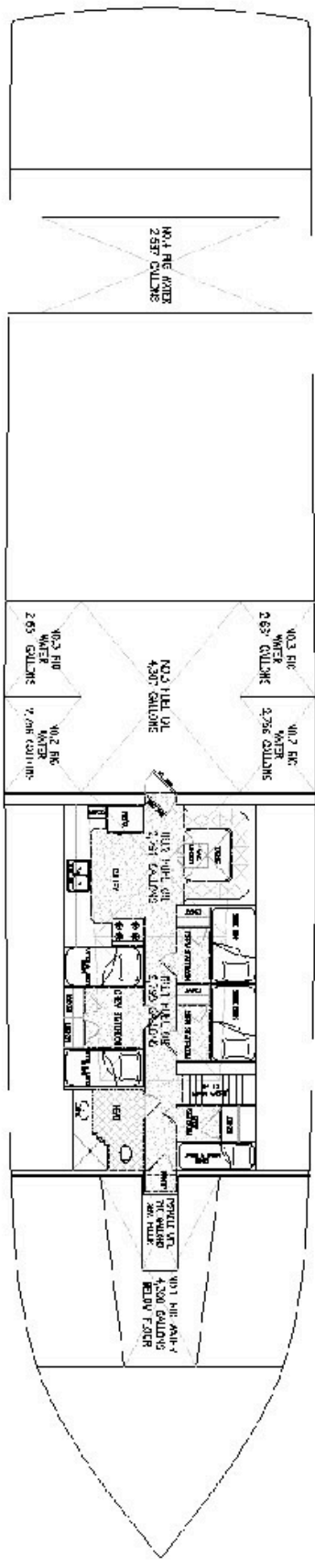

BH-5 R-33 BH-36 BH-3C R-18 BH-6 R-13 R-10 BH-8 BH-4