

1985 | 83.45m | FiFi I+II | 170 T BP DP2
Rescue / AHTS / Oil Recovery Vessel | For P&C Sale

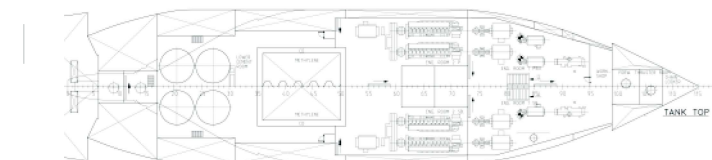

Specifications

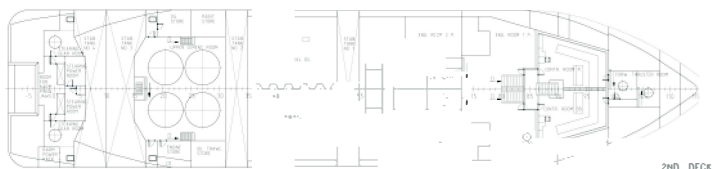
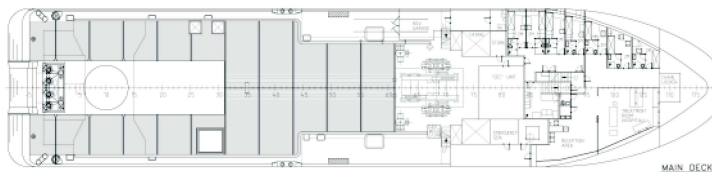
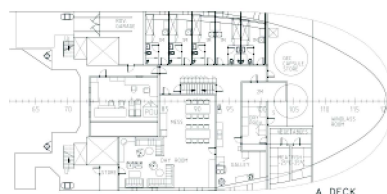
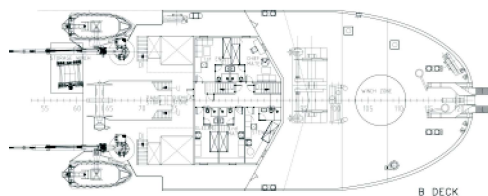
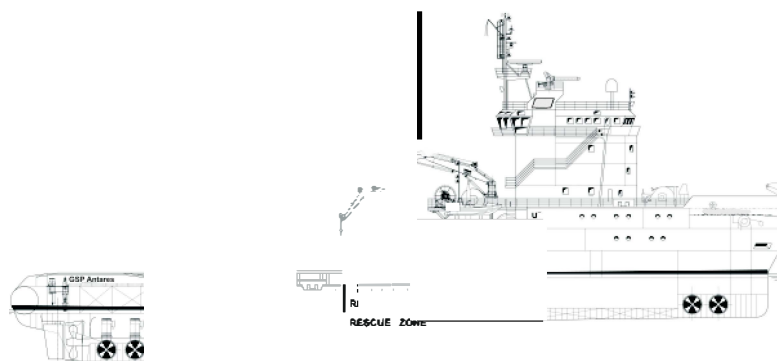

VESSEL TYPE

This multifunction Safety Service Vessel has two independent engine rooms (starboard and portside), enabling her to proceed at half power in case of a major accident, such as fire, explosion, collision etc. Each side thruster and steering gear with accessories are placed in separate watertight compartments. Two separate control rooms / panels can be operated either split or synchronised (normal mode). Propulsion with control systems have been arranged in such a manner that one single fault can only cause loss of power to one propeller / rudder.

The following functions are included:

- Standby - rescue
- Fire fighting
- Oil recovery - storage capabilities
- Inspection and maintenance of underwater loading systems
- Underwater inspections (ROV)
- Anchorhandling and towing
- Buffer storage of consumables
- Supply services incl. carriage of brine and low flashpoint liquids
- Emergency preparedness

TECHNICAL DETAILS

Classification

D.N.V. + 1A1 Tug / Supply Vessel - SF
FiFi I+II - Oil Rec. Dyn. pos. autr. - LFL, EO
DNV. ID.NO 14407

MAIN DIMENSIONS

Length over all:	83,45 m
Length b.p.p.:	73,85 m
Breadth:	18,00 m
Depth mld.:	7,95 m
Draft summer marks:	5,55 m
Freeboard summer marks:	2,40 m

TONNAGE

GRT:	3385
NR:	1015
Deadweight:	2,500 tonnes
Light ship weight:	3,032 tonnes
Displacement summer draft:	5,532 tonnes

CARGO DECK

Length 30,85 + 11,15:	42,00 m
Breadth:	10,0 / 15,5 m
Deck space 478 + 111,5:	589,5 m ²
Max deck cargo:	1,000 tonnes
Deck strength per m ² :	5 tonnes
Height of cargo rail:	2,775 / 1,565 mm

Specifications

COMMUNICATION EQUIPMENT

- FURUNO HF and MF main station w/Telex DSC
- 1 Navtex receiver 2 Skanty
- 1 Phonico Intercomm. Systems
- 1 VHF Aermobil FSG 60 m
- 1 Sailor Hospital Communication Systems
- 1 UNI-SAFE ELECTR. watch keeping receiver
- 1 UNI-SAFE ELECTR. sel call receiver
- 3 Skanti portable lifeboat radios
- 2 Epirb Jotron Tron 30S
- 3 GMDSS waterproof VHF-Sets
- 1 VHF Sailor R 2022 located in radiostation
- 3 VHF Station Sailor RT 146 on bridge w/slave station each bridge wing
- 6 Portable VHF sets for use on deck and in FRC's
- 6 Portable UHF-sets for on board use

NAVIGATION EQUIPMENT

- 1 x Radar, Furuno FAR 2030 S, S-Band with Arpa
- 1 x Radar, Furuno FRC-1411, X-Band with ARPA
- 1 x Radar, Furuno GD 2000 Video plotter w/inter switch
- 1 Furuno FD 525 VHF D/F
- 1 GPS - Receiver Furuno GP 90
- 3 Anchuts gyro compass STD 22
- 1 Sperry MK 37 gyro compass
- 1 Autopilot Robertson MK0
- 1 Furuno Echo sounder FE 700
- 1 Ben Doppler log

DYNAMIC POSITIONING SYSTEM

- Kongsberg Simrad SDP21
- 2 DGPS / Spot beam/ IALA/SBAS
- Hipap 350
- 3 Anchuts Gyro
- 1 Fanbeam
- Light weight tautwire in moonpool
- Artemis MK 4

LIFE BOATS AND MAN-OVER BOARD BOATS

1 powered MOB / lifeboat type Springer

RESCUE BASKETS

2 Bennex BRB 2500 MK 4

1 Dacon rescue scoop

INFLATABLE LIFE RAFTS

4x20 persons each + 2x12 persons each

Otherwise fully fitted in accordance with NMD requirements

for tug / supply / rescue vessels

ACCOMMODATION

- 7 single cabins for officers
- 5 single cabins for crew
- 10 double cabins for passengers
- Hospital with 10 bunks
- All cabins with shower and toilet

ROV GARAGES

One permanent ROV garage for Work Rov

One permanent ROV garage for Observation Rov

TANK CAPACITY (dedicated tanks)

Fuel, ships use:	486 m ³	for vessel's consumption only
Fuel, cargo:	798 m ³	abt. 250 m ³ /hr against 90 m
Special products (2 tanks) (brine/base oil):	767 m ³	abt. 150 m ³ / hr
Methanol:	211 m ³	abt. 150 m ³ / hr
Fresh water:	527 m ³	abt. 150 m ³ / hr against 90 m
Drill water:	932 m ³	abt. 150 m ³ / hr against 90 m
Dry bulk (4 tanks):	205 m ³	abt. 50 / 80 t / hr against 60 m
Rig chain lockers:	245 m ³	
Capacity rig chain:	76 mm	abt. 3,600 m
	92 mm	abt. 2,600 m
	102 mm	abt. 2,100 m
	111 mm	abt. 1,400 m

DECK EQUIPMENT / INSTALLATIONS

Anchorhandling / towing winch

1 Hydraulic make double drum waterfall AH / towing winch max. pull 300 tonnes, brake 430 tonnes.

Towing drum cap.: 1200 m 74 mm dia. wire

AH drum cap.: 1200 m 74 mm dia. wire

Both drums are disengageable, i.e. can be operated simultaneously or individually. Dynamic / static tension indicator for both drums. Towing drum also fitted with hydraulic brake and automatic tension compensator. Wildcats for 3" chain.

Extra pennant winch

1 double drum Hydraulic make

Capacities: 1,000 m and 1,500 m of 72 mm dia. wire each

Tuggers winches

2 Hydraulic make, 10 tonnes max. pull, with tension control

Capstans

3 Hydraulic make (1 forw., 2 aft.) 10 tonnes pull each

Anchor windlass and anchors

1 Hydraulic make, 22 tonnes anchor winch

2 x 750 m special chain cable, 46 mm dia.

2 anchors type Spek, 3,060 kos. each

Deck cranes

1 Hydralift make (stb.) Knuckle Jib- crane 5 t / 12 m

1 Hydralift make (port) Knuckle Jib- crane 5 t / 12 m

Towing pins

2 Ulstein make with safety locks, hydraulically operated from bridge

Anchorhandling tongs

2 Ulstein make (440 tonnes each) hydraulically operated from bridge or panels on aft deck

Hose handling equipment on forcast deck

- 1 A-Frame SWL 100 tonnes
- 104 tonnes on 1st layer, 0-6 m / min
- 1 Double drum hydraulic winch

Stern roller

Ulstein make, 450 tonnes, length 6,000 mm. dia 3,000 mm

Chain chaser type BEL 101

Grapnel type BEL 109

FIRE FIGHTING

FiFi, class I + II

3 water monitors total $7,200 \text{ m}^3 / \text{hr}$ + 1 foam monitor $300 \text{ m}^3 / \text{hr}$

Throw length at 40° elevation 210 m

Throw height at 60° elevation 120 m

Monitors are gyro stabilised and operated from bridge

Oil recovery

Tanks for recovered oil ca. $1,000 \text{ m}^3$

Dispersant gear for chemicals - tank 18 m^3

Complies with NOFO 87 requirements

MACHINERY

Propulsion

4 x Wichmann Diesel type AXAG, each 4,500 BHP at 475 r.p.m.

2 main gear boxes, Lohmann & Stolterfoht

2 c.p. propellers 3,900 mm dia. running in nozzels

Auxilleries

2 Caterpillar Diesel, each 675 BHP at 1,800 r.p.m. driving

2 Siemens generators, each 625 kVA

1 Caterpillar Diesel 137 BHP at 1,800 r.p.m. driving

1 Siemens generator 102 kVA

4 Siemens shaft generators, each 3,380 kVA at 1,800 r.p.m.

2 Atlas Copco compressors, each $22 \text{ m}^3 / \text{min}$

Side thrusters

2 el. driven bow thrusters, each 1,500 BHP

2 el. driven stern thrusters, each 1,200 BHP

BOLLARD PULL

170 tonnes continous bollard pull

Joystick control