

2017 | FIFI 1 | 72.2 T BP | ASD Tug for Private Sale

Brief Specs



Anchor Handling, tug and supply vessel
Fire Fighting Class 1
Built to Class ABS
Built 2017
5150 BHP
72.2 T Bollard Pull

Principal Particulars	
Flag	TBD
Built	2017
Shipyard	TBD
Class	✕ A1, ✕ AMS, E, FFV 1 AND TOWING VESSEL
Speed	12 Knots, free running speed

Dimensions	
Length Overall	32 m
Length B.P.	27.3 m
Beam	11.8 m
Depth	5.2 m (from base line)
Design draft	4.3 m (from base line)
G.R.T.	453
N.R.T.	136

Anchor Handling/Towing Part	
Anchor Windlass / FWD towing winch	1 X Electro- Hydraulic driven c/w Single drum with central divider duty pull 70 T @ stall and 60 T @ 0-10 m/min Brake holding 175 T
Towing / Anchor handling Winch	1 Electro-hydraulic single drum with auto mechanical spooling, Brake Holding 175 T @ 1 st layer, Rated pull 20 T @ 0-10 m/min
Stern Roller	SWL 50 T line pull

Anti-Pollution	
2 Spray Booms 4m (3 Nozzles each)	
Dispersant tank	10.4 m3

Fire Frightening	
Firefighting	FIFI 1
Foam Tank	10.4 m3
2 monitors (1,200 m3/h) throw 120 m [one water & one foam + water]	
2 pumps (1,400 m3/h) head 130 m.	

Life Saving / Rescue Equipment	
Life Raft	2 x 25 persons in addition to 2 x 15 persons Life Rafts, conforming to SOLAS convention

Capacities	
Deadweight	218 ton
Deck Strength	4 ton / m2
Clear Deck Area	90 m2
Fuel Oil	140 m3
Potable Water	44 m3
FW / Ballast	140 m3
Grey Water	5.4 m3
Black water	5.4 m3
Lube oil	5 m3
Hydraulic oil	1.8 m3
Dirty Oil	5 m3
Bilge	8.3 m3

Machinery & Propulsion Equipment	
Main Engines	2 CAT 3516C each 2575 HP / 1920 KW, 160 rpm
Generators	2 X Cummins QSB7-DM, each 110 KW (415V / 3PH. / 50Hz.)
Propulsion	2 X CPP Azimuth Rolls Royce

Navigation and Communication	
Radars	1 x FURUNO FAR-2117D 1 X FURUNO 1835
Satellite Compass	1 X FURUNO SC-502
GPS	FURUNO GP-170 with repeater
AIS	FURUNO FA-150
Echo sounder	FURUNO FE-800
SART	2 X Sailor SART II
Magnetic compass	1 X MK2000
GMDSS	A3
Search light	2 X 1000W with remote control

Accommodation	
Berths Total	10 Men
Mess room	1
Chiller / Freezer	3 X Chillers / freezers each 450 & one open top 320 L freezer

General arrangement

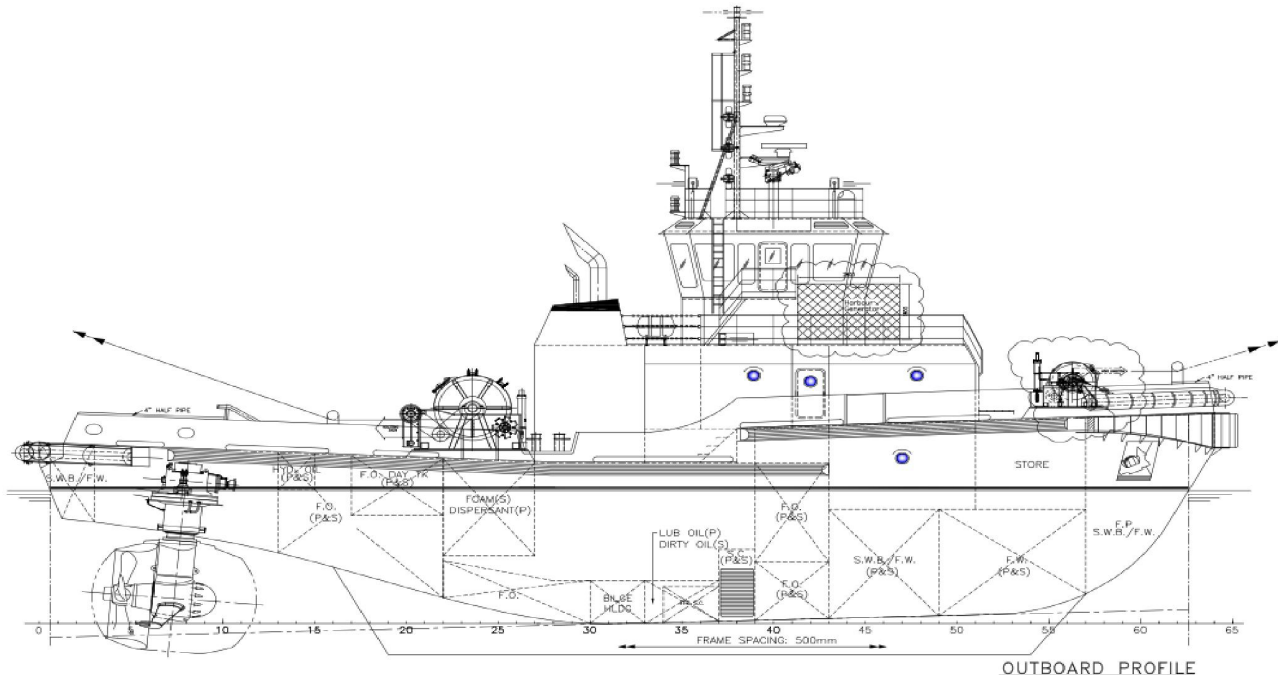

OUTBOARD PROFILE

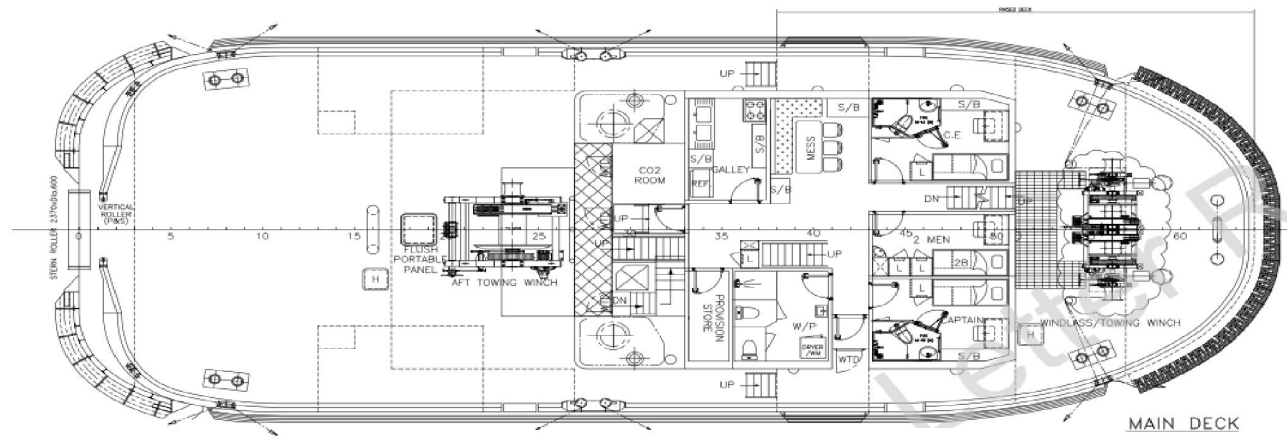

MAIN DECK