

SHIP PARTICULARS

150 Men Accommodation Work Barge



PRINCIPAL PARTICULAR

Type of Barge : Accomodation Work Barge
Flag : TBD
Year Built : 2009
Builder : Nantong Tongmao Shipbuilding Co., Ltd

DIMENSION

LOA : 85.34 m
Breadth : 24.38 m
Depth : 4.88 M
Class : BV, BKI
GRT : 4.486 tons
NRT : 1.345 tons
DWT : 3.951 tons

CARGO CAPACITIES

Deadweight : 3692.93 T
Deck Strength : 15T/sq.m
Clear Deck Area : 1000 Sq.Mtr (approx)
Fuel Oil : 755 MT (approx)
Fresh Water : 877.76 MT (approx)
Ballast Water : 3382.5 M3
Freezer / Chiller : 2 x 25.54 M3
Seawage Tank : 52.59 T
Dirty Oil : 18.93 T

PUMPS

Fuel Oil : 1 x 50 m3/hr @ 50 m/head
Fresh Water : 1 x 50 m3/hr @ 60 m/head
Ballast Water : 2 x 100 m3/hr @ 60 m/head

MACHINERY

Generator : 3 x 400 kw @1500 rpm, Cummins
Chongqing – Model KTA19-D-(M)
Alternator : 500kVA, 0.8pf, 400kW, 400V, 50Hz
Emergency Generator : 1 x 108 hp Cummins Marine – Model
6CT8.3 – GM115
123.75 kVA, 0.8pf, 99kW, 400V, 50Hz

DECK EQUIPMENT

8-point Mooring : 4 x Diesel driven drum waterfall winch
(TITAN)
16 vertical sheaves & 8 fairleaders
Drum Cap 1200m (L) x 40mm (Ø)SWR
16 vertical sheaves & 8 fairleaders
Brake Capacity : 224 kN
Anchor Wire : 9 x 1200 m (L) x 38 mm (Ø),
6*36WS+IWR-40 Galvanized –
Weight in Air 705 kg/100 mtrs)
Anchors : 10 x 5000 kg Flipper Delta Anchors
Suitcase Buoy : 10 x 2.5m (L) x 1.88m (Ø), Buoyancy 5.0
mt
Capstan Winch : 4 x 10 mt, Electric Drive
Pedestal Crane : Favco Model 15/10K,
Max. SWL : 70T @6.8m Rds,
Boom Length : 45.8 Mtrs
Deck Lighting : 16 pcs (1000/800 & 400 Watt)
Rescue Boat : 1 (SCM12-3,5R, Winch 04 – 03E)
w/ Davits (Max SWL 10 kn, Testload Stastic 22kn)
Gang Way : 3 Parts : 21m x 8m x 4m
Garbage Bin : 2Pcs : 2m x 2m x 1.50m

AUXILIARY EQUIPMENT

Oil Water Separator : 1 x 1.0 m3/hr (BOSS ST107)
Sewage Treatment Plant : 1 x 150 men/day + 11 m3/day
Water Maker : 2 x 20 M3/day (Reverse Osmosis)
Bilge Holding Tank : 31.55 m3
Air Compressor : 2 x 0.7 mpa (7 bar 99 psi)

RADIO & NAVIGATION EQUIPMENT

GMDSS : Sea Area A1 + A2
SSB : 1 x Furuno FS-1570
Link Sintel – Tel Net (F.B.B): 1 x Sailor 150 Fleetbroad band
VHF Radio : 2 x Furuno FM 8800 with built-in
DSC
Navtex Receiver : 1 x Furuno NX 700
SART : 2 x Mc Murdo S4
EPIRB : 1 x Mc Murdo E5
GMDSS, VHF Radio : 3 x Mc Murdo R2
Portable Marine VHF Rdo (IS): 8 x Motorola GP-328
Radar : 1 x Furuno 1932 MK2

Echo Sounder (Color) : 1 x Furuno FCV700
 GPS, GPS Compass : 1 x Furuno GP32,
 1 x Navigator GP150
 Weather Fax : 1 x Furuno FAX 408
 AIS : 1 x Furuno FA150
 Magnetic Compass : 1 x Daiko T-150B
 Wind Monitor / Tracker : 1 x Young 05103-58
 Air Band VHF (Hand Held) : 1 x Icom IC-A6
 Helicopter Communication : 1 Set Non DF Radio
 Equipment Beacon, VR-125/250
 VHF Airband Transceiver : 1 x IC-A110
 VSAT COMTECH CDM 570L: 1 unit

Helideck : Designed to suit Sikorky-61 or equil.
 (Deck strength 9.3 T/22.2 Sq.M)
 CONSUMPTION : 2 Gen Running : 4 M3
 3 Gen Running : 7 M3

ACCOMMODATION

Single berth : 5 x 1 berth (5 men)
 Double berth : 3 x 2 berth (6 men)
 Four (4) men berth: 35 x 4 berth (140 men)
 Total : 151 men
 All cabins fully air-conditioned
 (AHU Central Air Cond' System on MthDK, Level 1, Level 2)

Barge also fitted with Vingtor PA Talkbalk System and Sound
 Powered; Telephones (22 lines); Batteryless Telephone
 Vingtor (VSP-213-L) 6 lines

FIRE FIGHTING & SURVIVAL EQUIPMENT

Ballast/Bilge/GS : 2 x 100 m3/hr @ 60m/head
 100m3
 Fire Pump (Main Fire Pump): 1 x 150 m3/hr @ 600m/head
 Life Rafts : 12 x 25 men SOLAS Approved
 Sprinkler Jockey Pump : 1 x 3 m3/hr @ 112m/head
 Rescue Boat : 1 x 6 persons with outboard
 engine driven
 : as per SOLAS (RB400) approved
 type 25 HP

Fire Detection & Alarm System in All enclosed spaces
 Fixed CO2 system generator room, paint store, pump room
 Fixed automatic water Sprinkler system for whole
 accomodation spaces

OTHER FACILITIES

Hospital : 1 x double berth hospital with attached
 paramedic room
 Galley : 1 w/ cooking utensils, refrigerators etc.
 (Prov' 25.54M2/Freezer 25.54 & Chiller
 25.54M3)
 Messroom : Level 1 (64 M2) Seating capacity men
 Woode Area : 38m x 16m = 600m
 Offices : 2 Rooms on Main Deck
 Conference Room: 1 with seating capacity for 18 men
 (LAN-Type A available)
 Others : 1 x Prayer Room
 1 x Laundry/Drying Room
 1 x Dry Provision Room
 1 x Winch Control Room
 1 x Barge Radio Room
 Winch Control : 1 c/w VHF/SSB & CCTV system for winches
 Room
 Gym Room : 1 on Main Deck fitted with 5 sets Gym
 Equipments
 Changing Room : 1 on Main Deck w/ 150 locker
 Work Shop : 1 on Main Deck c/w Lathe, Drill, Grinder,
 2 Welding Machines, Electric Saw
 2 Air Compressor (3 bar), Thread Machine

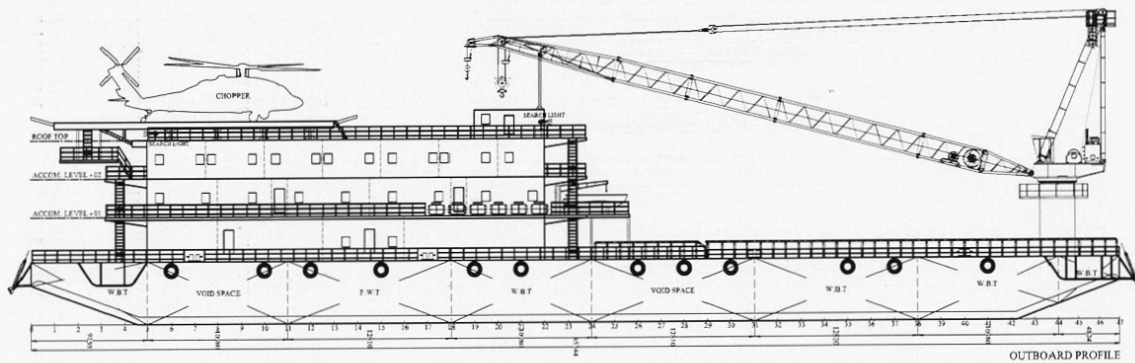

OUTBOARD PROFILE

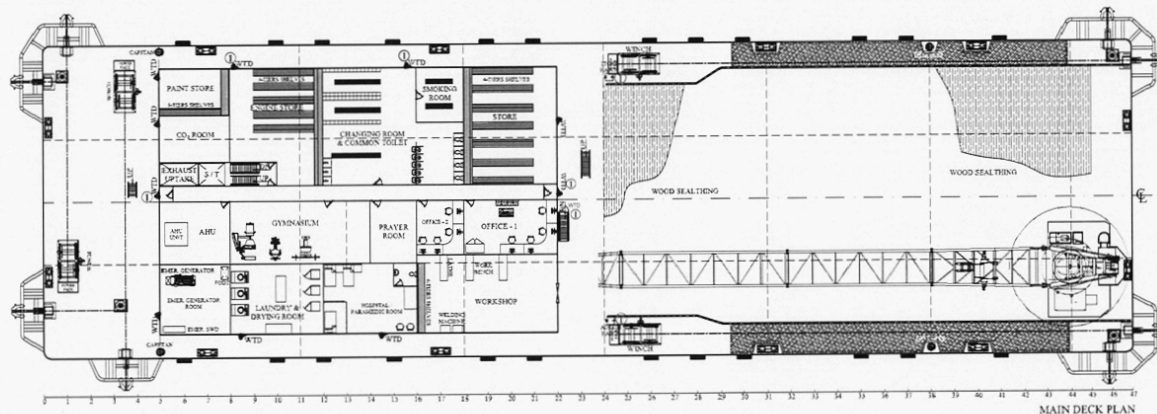

MAIN DECK PLAN

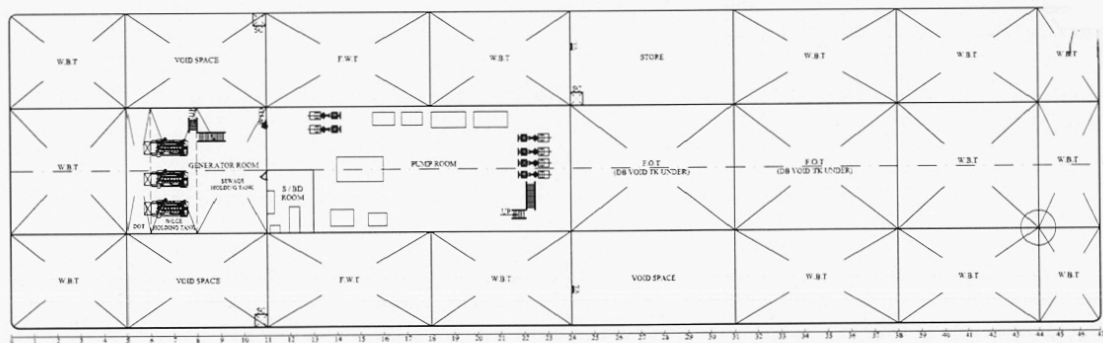

BELOW MAIN DECK PLAN

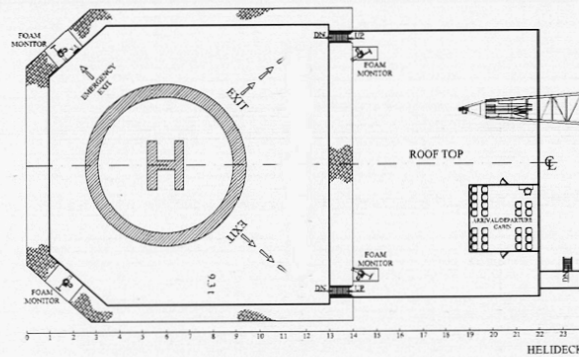

HELIDECK

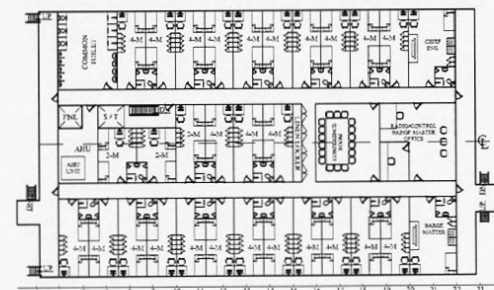

ACCOMMODATION LEVEL - 02
214x MEN, 342 MEN, 95 MEN = 95 MEN

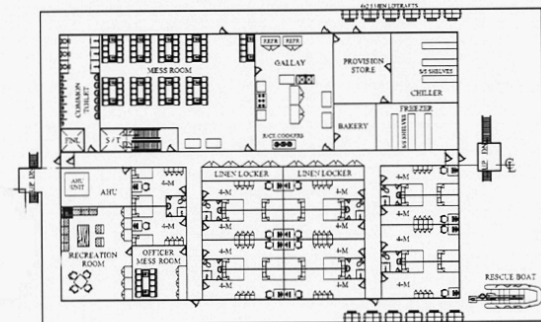

ACCOMMODATION LEVEL - 01
144x MEN = 56 MEN

PRINCIPAL PARTICULARS	
L. O. A.	: 85.34 m (280.00 FT)
BREADTH	: 24.38 m (80.00 FT)
DEPTH	: 4.880 m (16.00 FT)
COMPLEMENT	: 150 Orang
FUEL OIL	: 755 Tonnes (approx.)
FRESH WATER	: 900 Tonnes (approx.)
CLEAR DECK SPACE	: 899.02 m ²
MAX. PERMISSIBLE DK'	: 15 Ton/m ²
LOAD AT MAIN DECK	
MAX. PERMISSIBLE DK'	: 5 Ton/m ²
LOAD AT TRUNK DECK	