



---

240' ANCHOR HANDLING TUG SUPPLY VESSEL

## REGISTRATION

Vessel Type	Anchor Handling Tug Supply Vessel
Year Built	1986
Year Converted/Modified	2002

## DIMENSIONS

Dimensions	240 ft. X 52 ft. X 18 ft. 5 in. (73.15 m X 15.85 m X 5.64 m)
Design Draft	15 ft. (4.57 m)
Draft (Maximum Operations)	15 ft. 8 in. (4.78 m)
Loadline Displacement	3,770.18 LT (3,830.68 MT)
Clear Deck	135 ft. x 44 ft. (41.15 m x 13.41 m)
Cargo Deck Area	5,940 sq. ft. (551.82 sq. m)
Deck Cargo Capacity	830 LT (843.32 MT)
Deadweight Tonnage	1,527 LT (1,551.50 MT)

## CAPACITIES

Fuel Oil	178,576 gals. (675.98 cu. m)
Ballast	325,615 gals. (1,232.59 cu. m)
Fresh Water	23,068 gals. (87.32 cu. m)
Dry Bulk	5,120 cu. ft. @ 45 psi (144.98 cu. m @ 3.1 bars)
Liquid Mud	2,200 barrels (349.77 cu. m)

## MACHINERY

Main Engines	Three (3) EMD 20-645 E7, 10,800 BHP
Propulsion	Three (3) CPP
Total Propulsion HP	13,200 HP
Bow Thrusters	Two (2) 150TV-D Tunnel
Stern Thrusters	One (1) 1,200 HP NASB/Ulstein 360° Jet Azimuthing
Ship's Service Generators	Two (2) x 500 kW
Shaft Generators	Three (3) x 2,400 HP/1,800 kW

## TOWING AND ANCHOR HANDLING (DECK EQUIPMENT)

Winches	Brattvaag BSL 350 W Double Drum with chain mouse
Line Pull	350 MT or 926,100 lb line pull or 926 KIPS line pull per drum
Chain Lockers	Two (2) x 6,000 ft. (1,828.8 m) of 3.5 in. (8.89 cm) chain each
Storage Reels	Two (2) x 11,480 ft. (3,499.10 m) of 3 in. (7.62 cm) wire
Wire Capacity	Two (2) x 9,800 ft. (2,987.04 m) of 3 in. (7.62 cm) wire per drum @ 350 MT

## SPECIAL FEATURES

Shark Jaws	One (1) x 350 MT
Tow Pins	One (1) x 350 MT
Tuggers	One (1) x 12-Ton Forward
Tuggers	Two (2) x 10-Ton Aft
Positioning	DP 2
Stern Rollers	One (1) x 8 ft. x 6 ft.
Cranes	Two (2) x 10 tons @ 30° radius
Firefighting	Two (2) Monitors @ 12,500 GPM

## ROV

ROV	Schilling Robotics 200HP UHD rated for 4,000 m
-----	--

## LIFE SAVING EQUIPMENT

Life Rafts	Four (4) x 25-Man Life Rafts
Rescue Boat/Craft	One (1) x Narwhal SV-400 SOLAS FRC

## ELECTRONICS

Electronics Package	Two (2) Furuno FR-2115 Radars, GMDSS, Iridium Satellite Phone, Marine Technologies Bridge Mate DP 2, Marine Technologies Bridge Mate Autopilot, Furuno Color-View Depth Sounder, Furuno VHF FM-8500 @ Winch Operator Panel, Seven (7) Color Monitors, JRC NO2-127C Inmarsat-C Telex (GMDSS), SEA 222 Single Sideband Radio with Ringer, JRC NCH-802 Controller MF/HF Radio, JRC NCR-300A Navtex, Furuno GP-150 GPS, Furuno FA150 AIS
---------------------	--

**CLASSIFICATION**

---

ABS	Steel Tug and Supply Vessel
ABS	Maltese Cross A1 (Towing Service)
ABS	Maltese Cross AMS
ABS	DP 2

**ACCOMMODATIONS**

---

Accommodations	34
----------------	----

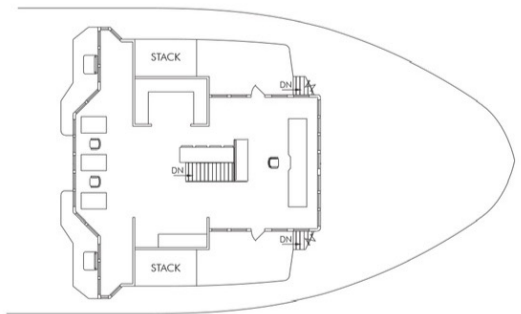
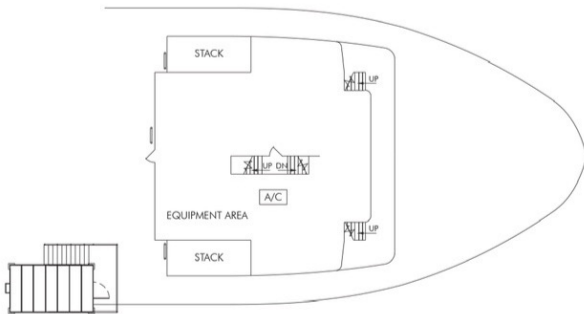
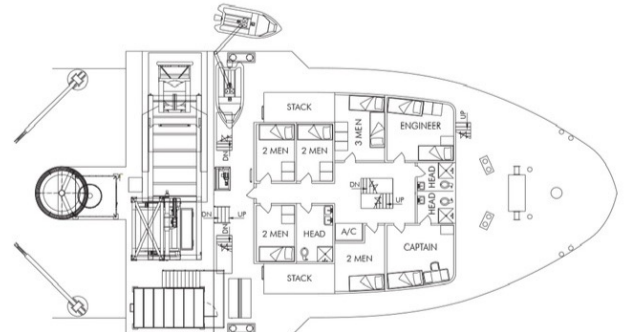
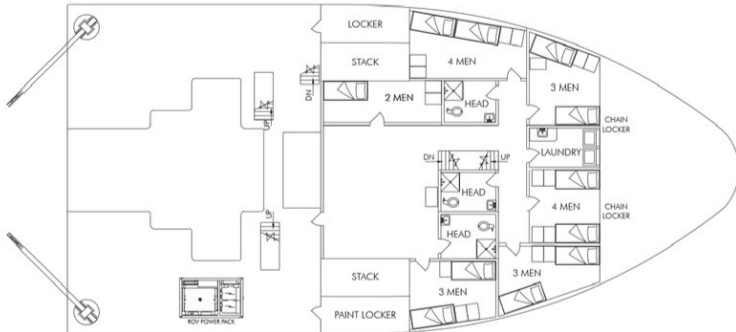
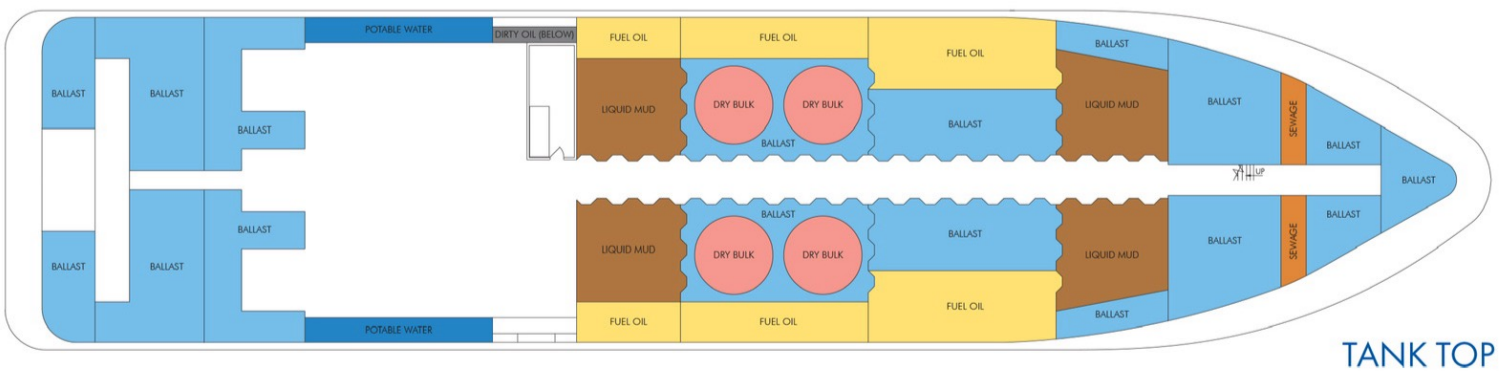
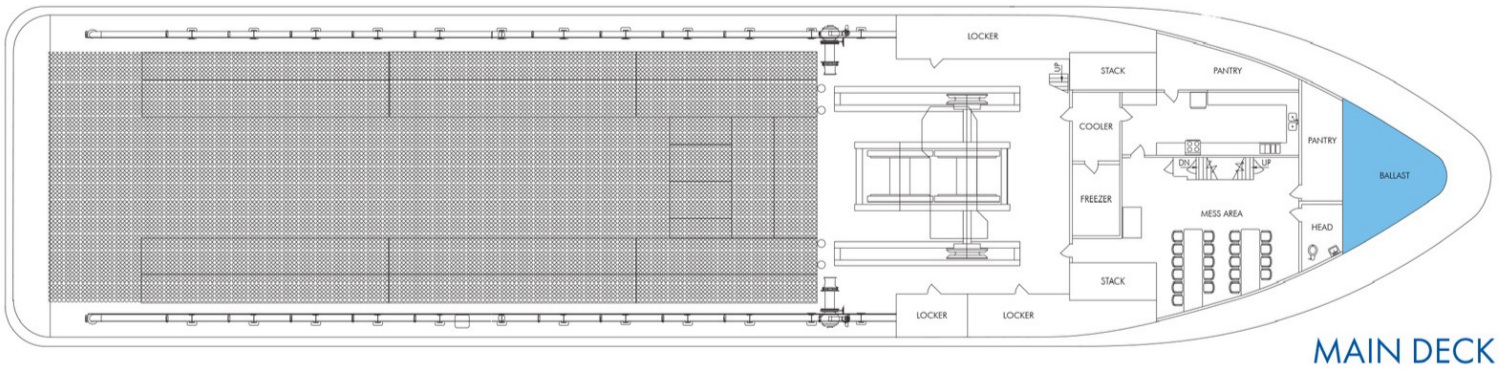

- Brine/Drill Water
- Ballast/Fresh Water
- Fuel Oil
- Liquid Mud
- Dry Bulk
- Anti-Roll
- Auxiliary
- Dirty Oil
- Fuel Oil Overflow
- Potable Water
- Sewage
- Void/Cofferdam
- Wash Water
- Liquid Mud Cleaning
- Methanol

All specifications subject to change.