

FLEX-40SC MAX

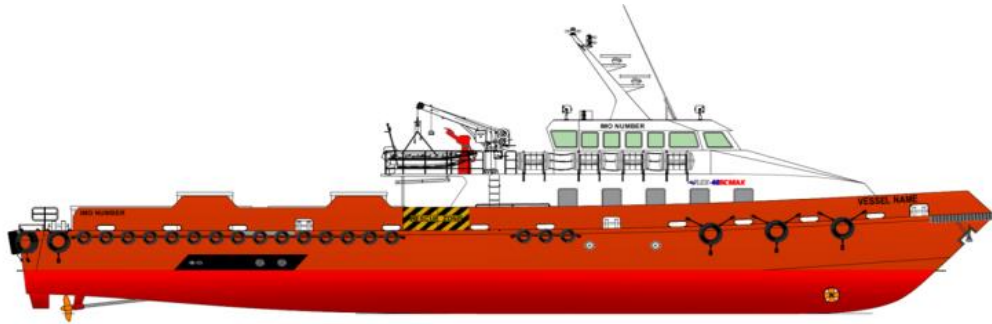

VESSEL OVERVIEW

Vessel Type:	Aluminium Monohull Fast Multi-Role Vessel with Caterpillar-Powered Flex-40SC
Classification:	BV I ✳ HULL • MACH, Crew Boat, Sea Area 3
Safety Regulation:	BV and Panama Flag State requirements
Regs, Codes, Guidelines:	MARPOL, SOLAS, IMDG

HULL PARTICULARS

Length Overall:	40.00 m
Breadth Moulded:	7.60 m
Depth Moulded:	3.65 m
Loaded Draft:	1.89 m

CARGO DECK

Clear Deck Area:	93 sqm
Deck Cargo Capacity:	60 MT
Deck Strength:	2.0 MT / sqm
Deck Dimensions:	16.9 m x 5.5 m
Cargo Railing Height:	1.0 m
Deck Store:	Fitted
Remarks:	Adequate cargo retainers and lashing lugs on both sides for securing deck cargo

TONNAGE

GRT:	272 MT
NRT:	81 MT
DWT:	131 MT

MAIN MACHINERY

Number of Main Engines:	3 units with resilient mountings
Make / Type:	Caterpillar C32 ACERT IMO Tier 2
Total BHP:	3 x 1450 BHP @ 2300 rpm
Propellers:	3 x fixed pitch, Ni-Al-Bronze, 5 blades
Bow Thruster:	1 unit electro-hydraulic @ 100 HP

PERFORMANCE

Maximum Speed:	28 knots @ 100% MCR
Maximum Fuel Consumption:	878 L / hr
Economical Speed:	26 knots @ 85% MCR
Economical Fuel Consumption:	765 L / hr

GENERATORS AND AUXILIARY ENGINES

Generators:	3 x Caterpillar SR4 Alternator 86 ekW
Prime Movers:	3 x 125 BHP @ 1500 rpm
Make / Type:	Caterpillar C4.4
Vessel Power Supply:	415/220 Volt AC, 50 Hz, 3-phase + 24 Volt DC
Shore Power / Reefer Sockets:	1 / 4

SAFETY EQUIPMENT

Life Rafts:	4 x 25-man each side as per SOLAS
Life Jackets:	88 on board as per SOLAS
Life Buoys:	8 on board as per SOLAS
Scrambling Nets:	2 units
Other Equipment:	Pyrotechnics, line-throwing apparatus
Rescue Zone:	Port and Starboard

EMERGENCY RESPONSE FEATURES

1 x external FiFi monitor with remote clutch and control @ 600 cbm per hour
Aerosol fire extinguishing system
SOLAS rescue boat with Davit

ACCOMMODATION AND STORAGE

MAIN DECK

Passenger Seats:	Economy Class, 70 pax
Seating Arrangement:	2-3-2 (max 3 seats per row)
Seat Pitch:	900 mm
Passenger Toilets:	2 cubicles with showers
Entertainment System:	2 x LCD TV screens
Passenger Chill-Out Lounge:	Fitted
Utility Room:	Fitted

BELOW MAIN DECK

Crew Cabins / Total Bunks:	4 / 10 (3 x 2-man, 1 x 4-man)
Crew Toilet:	1 cubicle with shower
Entertainment System:	1 x LCD TV screen
Crew Mess and Galley:	Fitted
Crew Washer and Dryer:	Fitted
Separate Walk-In Freezer and Chiller:	Fitted
Dry Store:	Fitted
Work Bench:	Fitted

ELECTRONICS AND CONTROLS

GMDSS:	Sea Area A1+A2
VHF:	Sailor 6222
MF/HF Radio:	Sailor 6310
BNWAS:	LeGuardian2025
Marine Radar:	Simrad HALO-3
GPS:	Simrad P2005
Depth / Echo Sounder:	Simrad P319
Satellite Compass:	Simrad P3007
Magnetic Compass:	Riviera 6"
Navtex Receiver:	JMC-NT-1800
Public Address / Intercom System:	Vingtor Zenitel
Search Lights:	3 x 1000W
EPIRB:	McMurdo E8
SART:	McMurdo S5A
AIS:	Simrad V5035
CCTV:	12 units fitted (7 x Exterior, 1 x Bridge, 1 x Passenger Area, 1 x Mess Room, 2 x Engine Room)

TANK CAPACITIES

Fuel Oil:	82,000 L
Bunker Flowmeter:	Fitted
FUELTRAX EFMS:	Ready
Fresh Water:	30,000 L
Grey Water:	500 L
Oily Bilge:	600 L
Lube Oil:	450 L
Gear Oil:	450 L
Hydraulic Oil:	450 L
Fuel Oil Sludge:	500 L
IMO-Approved Sewage Treatment Plant:	Fitted for 15 pax
IMO-Approved Oily Water Separator:	15 ppm

OPTIONS

FUELTRAX electronic fuel management system

MAIN PARTICULARS

LENGTH OVERALL : 40.00 M
 LENGTH BET. PERPENDICULAR : 36.51 M
 LENGTH WATERLINE : 37.45 M
 BREADTH MOULDED : 7.60 M
 DEPTH MOULDED : 3.65 M
 DESIGN DRAFT : 1.89 M
 COMPLEMENT : 10 CREW
 70 OFFSHORE WORKERS
 CLASS NOTATION : BV I * HULL * MACH, CREW BOAT, SEA AREA 3

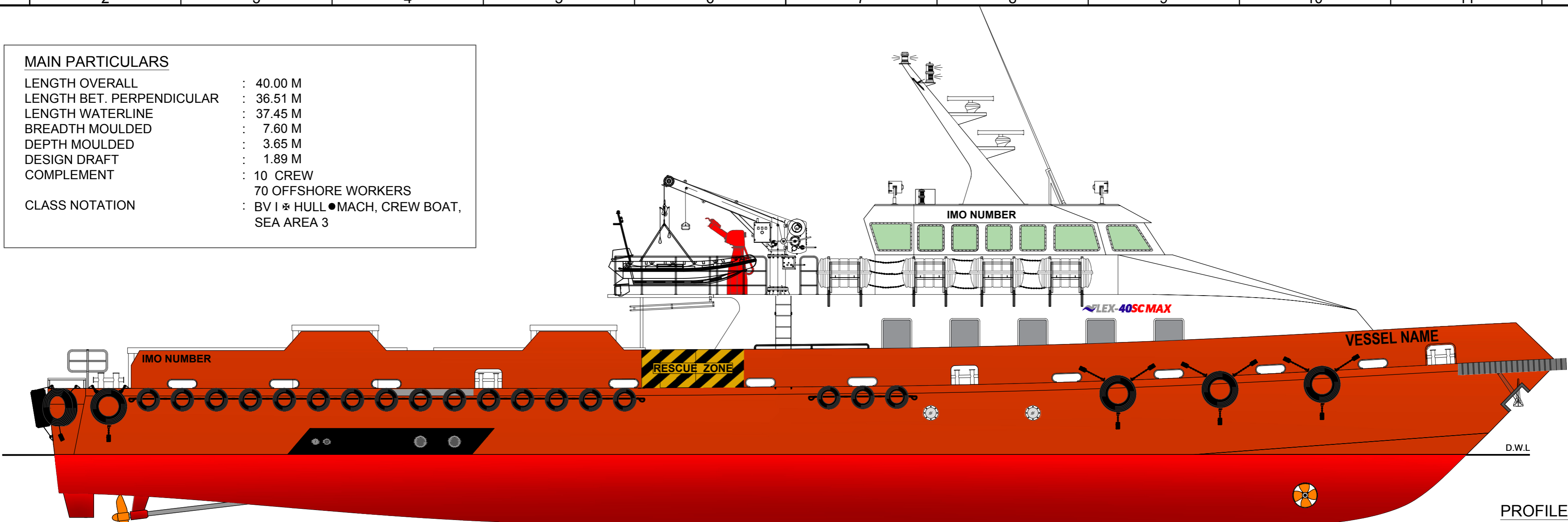

PROFILE

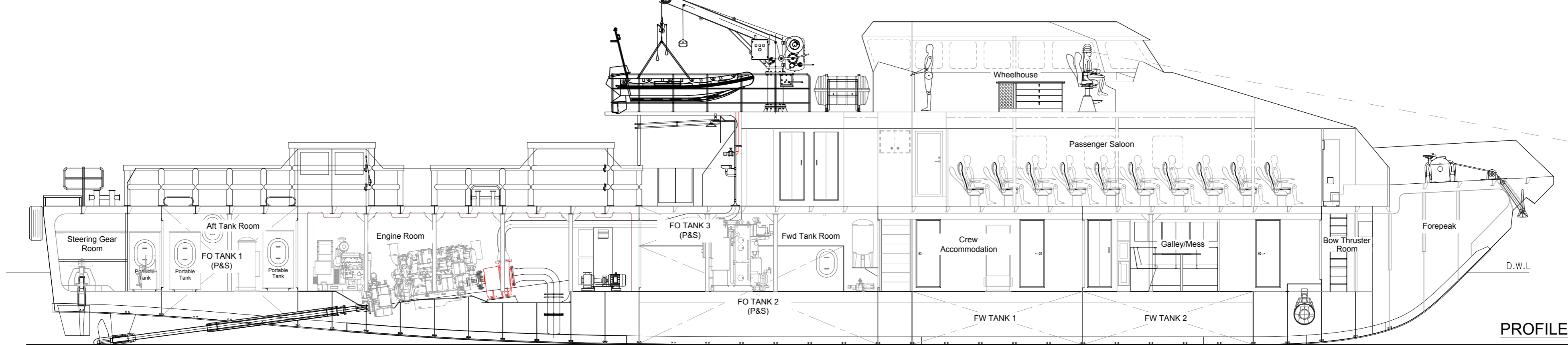
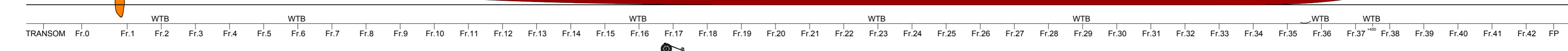

PROFILE

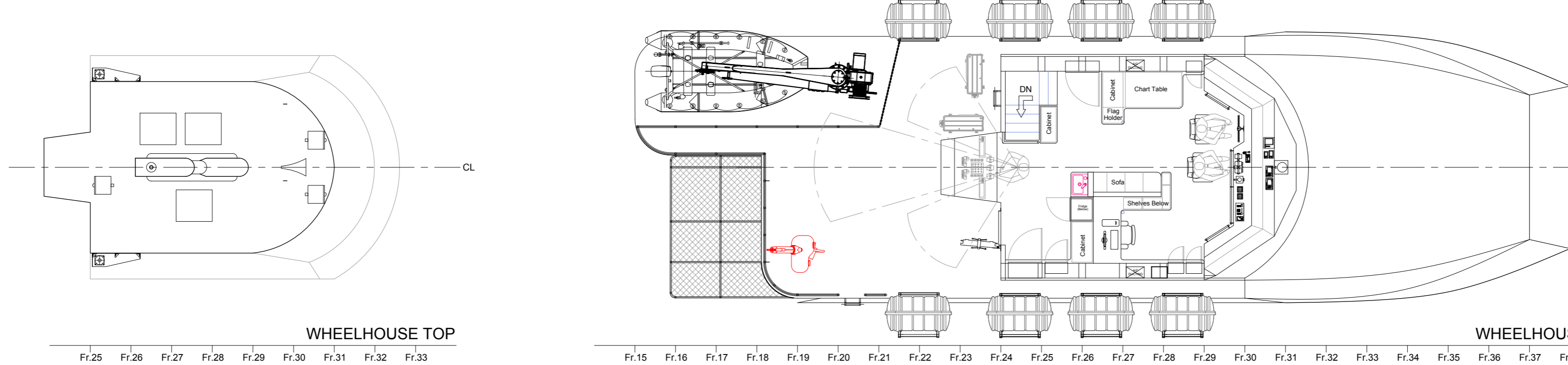
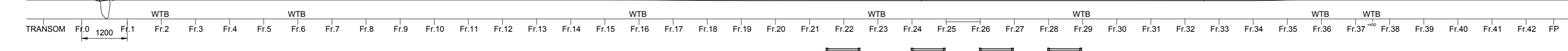

WHEELHOUSE TOP

WHEELHOUSE

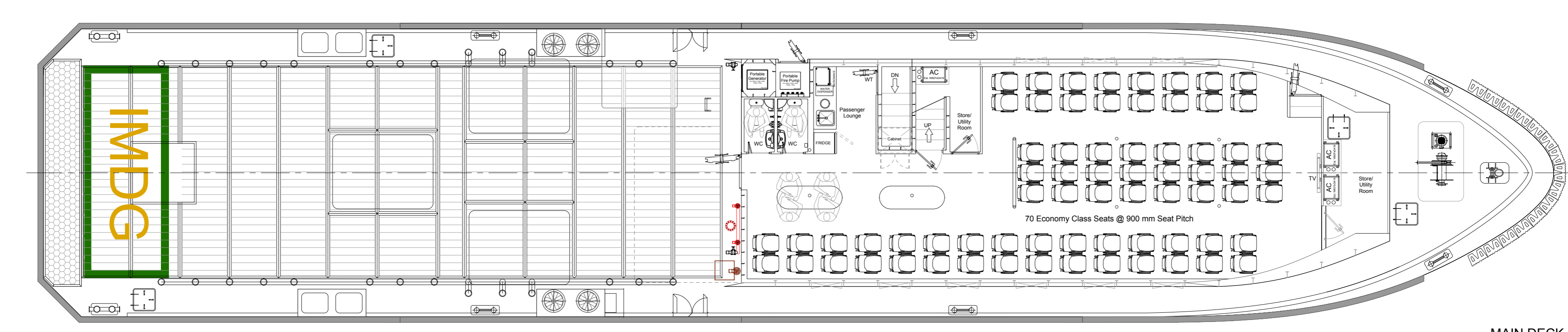

MAIN DECK

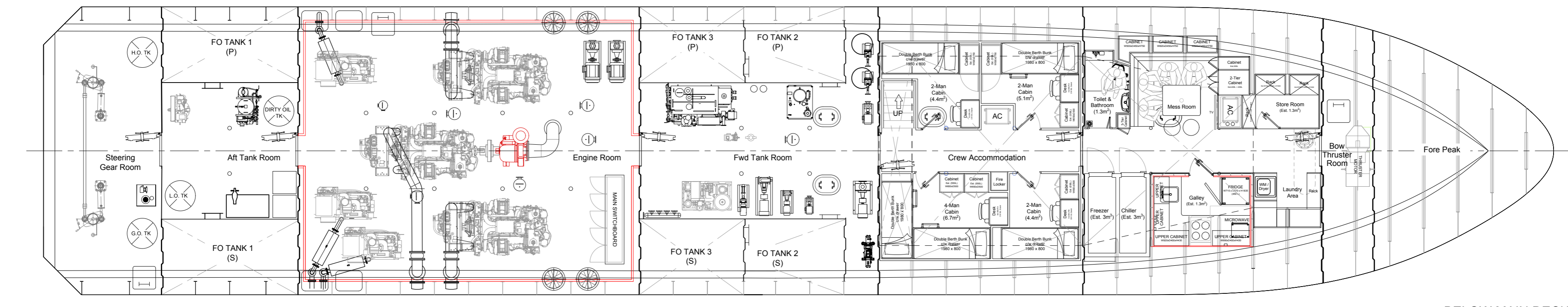
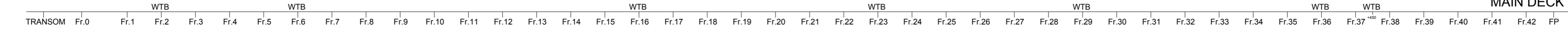

BELOW MAIN DECK

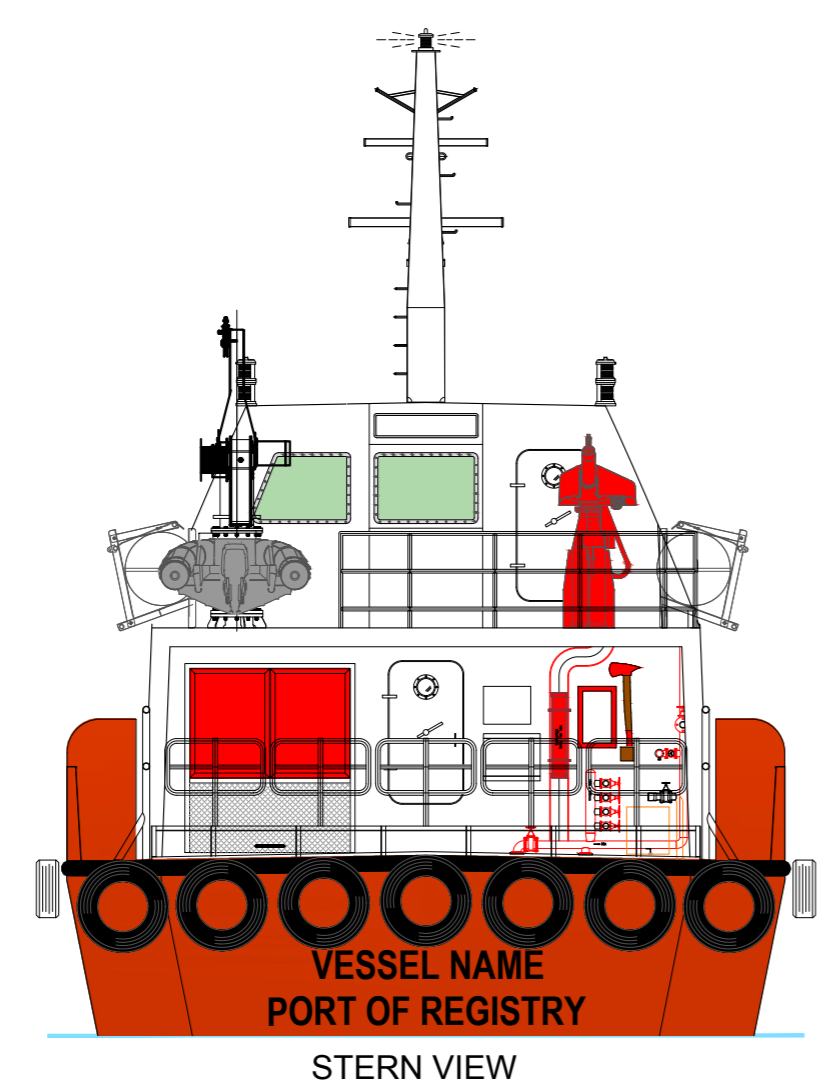
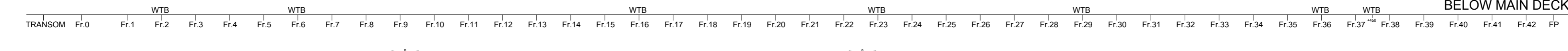

STERN VIEW

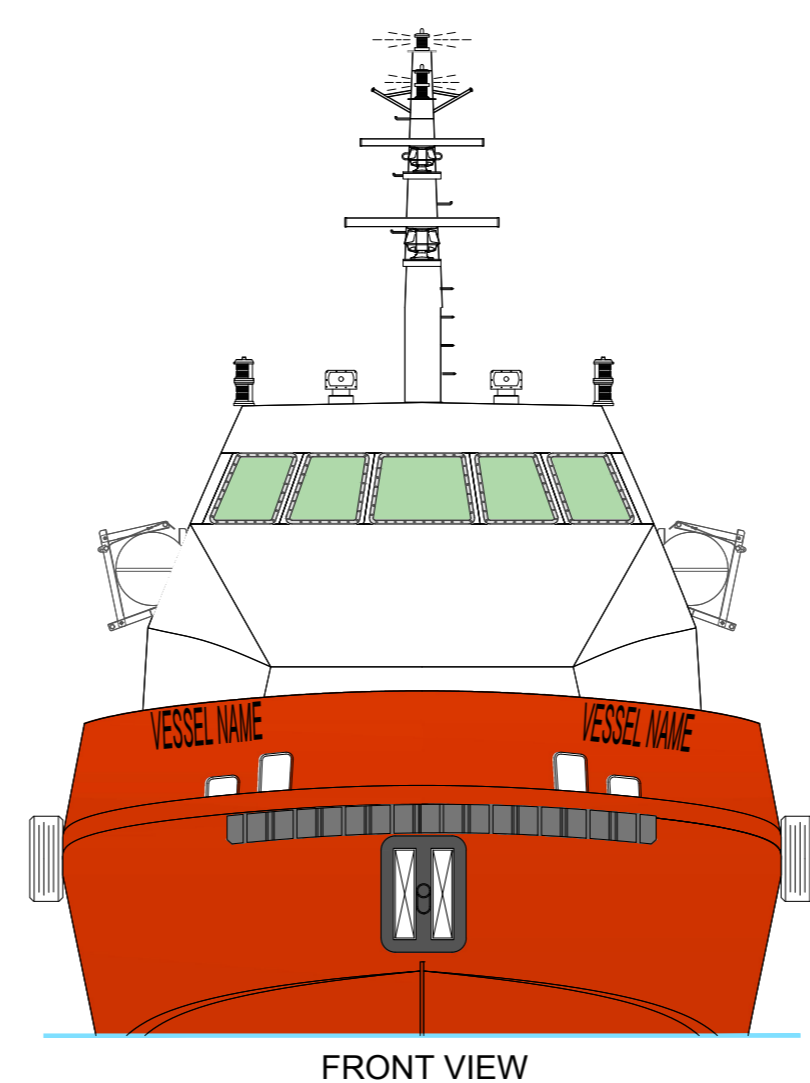

FRONT VIEW



Project: Flex-40SC MAX
 Title: General Arrangement
 70 Pax
 Date: 11-04-2021
 Sheet: 1 of 1
 Revision: A