

85m / DP-2 MPSV/ IMR/ ROV with 150 MT SWL Knuckle Boom Jib Crane Capabilities

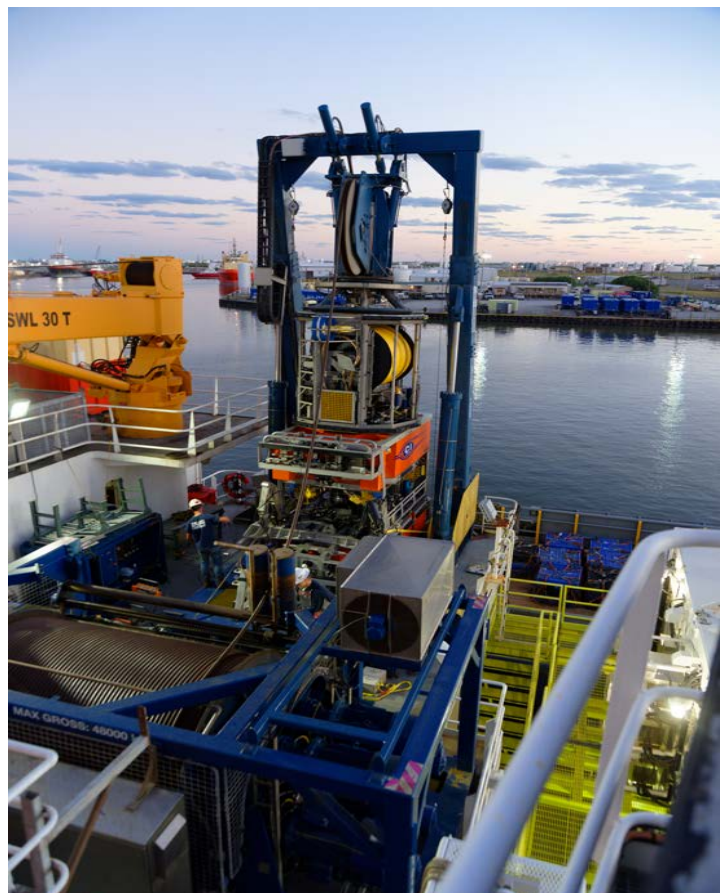

Vessel offshore construction capabilities include both the installation or decommissioning of subsea trees, rigid and flexible jumpers, flying leads, manifolds, suction piles and vast array of other subsea scopes of work. The vessel is equipped with 2 ROV's and is capable of towing including supplying massive deepwater rigs offering immense above and below deck cargo capacities.

Main Applications:

- Subsea construction & installation
- Maintenance, repair, platform decommissioning and ROV support
- SAT & Air Diving Operations
- Towing Operations



GENERAL SPECIFICATIONS

Hull	805
Vessel Type	MPSV - Multi-Purpose Support Vessel
Vessel Class	OSV - Offshore Supply Vessel
Year Built	1999
Shipyard	Halter Marine
FLAG	TBD Upon NCNDA Completion
IMO	TBD Upon NCNDA Completion

DIMENSIONS

Dimensions	279 ft. X 65 ft. X 26 ft. (85.04 m X 19.82 m X 7.29 m)
Length Overall	280 ft. / 85.3 m
Draft (Lightship)	13.4 ft. (4.08 m)
Draft (Loadline)	21 ft. - 11 in. (6.7 m)
Clear Deck	140 ft. x 55 ft. (42.67 m x 16.76 m) 715 sq. m
Cargo Deck Area	7,700 ft ² (715.34 m ²)
Deck Cargo Capacity	400 LT (406.4 MT) @ 3' VCG
Deadweight Tonnage	3,208 LT (3,259 MT)

CLASSIFICATION

ABS	(DPS - 2) Maltese Cross Dynamic Positioning
ABS	(A1) Maltese Cross (Hull)
ABS	(AMS) Maltese Cross AMS (Machinery)
ABS	(E) Circle E Equipment
ABS	(HELIDK) Heli-Deck Notation
ABS	(CRC) Crane Register Certificate
USCG	Subchapter I (Cargo), Subchapter L (OSV)
SOLAS	Cargo Ship
MARPOL	i.a.w. Interpretation of MARPOL A.673

CAPACITIES

Fuel Oil	309,309 Gallons (1,170 m ³) @ 100%
Ballast	528,629 Gallons (2,001 m ³) (Includes Flume Tank)

CAPACITIES

Potable Water	99,962 Gallons (378.4 m3)
Liquid Mud	7,438.4 Barrels (1,182.5 m3)

SPECIAL FEATURES

Tuggers	Four (4) x 20 Tons (each)
Ship Motion	FLUME Stabilization Tank
Ship Motion	Bilge Keels
Positioning	DPS - 2
Deck Crane	Two (2) x 25 ST (22.6 MT) @ 10' with 40' Extended Range (EBI Cranes)
Firefighting	One (1) x SKUM MK150 Fire Monitor
Helideck	Modular aluminum construction. Certified for Sikorsky S-92 helicopter. Certified under CAP 437, day or night operations

MACHINERY

Main Engines	Four (4) x EMD 16-710-G7B, 16,000 BHP
Propulsion	Two (2) x LIPS Z-Drives, 6,000 BHP (each)
Propulsion	4xBradley DC Electric Motors @ 3,000hp each. 2-coupled together per Z-Drive
Bow Thrusters	One (1) x HRP 500-60, 800 HP Tunnel Thruster, FPP, Electric Driven
Drop Down Thrusters	One (1) x HRP 630-51, 1,500 HP, Electric Driven
Speed	12 knots
Generators	One (1) x CAT 3508 Diesel Generator, 450 kW @ 1,200 RPM
Emergency Generators	One (1) x 190 KW, CAT 3306 (Radiator Cooled)
Ship's Service Generators	Four (4) x EMD Gensets, 2,865 kW (each) @ 900 RPM

TOWING AND ANCHOR HANDLING (DECK EQUIPMENT)

Tow Winch	Two (2) 11,800 ft. of 3 in. wire, 10,200 ft. of 3.25 in. wire, 8,800 ft. of 3.5 in. wire
Tow Drums	One (1) 20,600 ft. of 3 in. wire, 11,800 ft. of 3.25 in. wire, 16,500 ft. of 3.5 in. wire
Tow Pins	Two (2) x 300 MT SWL with Extended Length (Triplex S-300)
Tow Pins	Four (4) x Triplex TP-48 (Vertical)
Shark Jaws	Two (2) x 700 MT SWL (Triplex H-700)

TOWING AND ANCHOR HANDLING (DECK EQUIPMENT)

Stern Rollers	Three (3) x 700 LT (711 MT) SWL, (Teo (2) @ 10' dia. x 15'-9") (One (1) @ 10' dia. x 9'-0")
Chain Lockers	Two (2) x 11,500 cu. ft. (325.64 cu. m)
Storage Reels	One (1) @ 10,000 ft. of 3.5 in. wire ea.

LIFE SAVING EQUIPMENT

Life Rafts	Six (6) x 25-Person Inflatable Life Rafts
Life Rafts	Two (2) x 20-Person Inflatable Life Rafts
Rescue Boat/Craft	One (1) x Rescue Boat and Davit

SUBSEA EQUIPMENT

ROV	One (1) Schilling Robotics 200HP UHDS rated for 4,000 m
A-Frame	One (1) x 15 MT Hawboldt A-Frame's
ROV Winch	One (1) x MASH-4500 Macartney Winch with 4,100m Umbilical
Sub-Sea Crane	One (1) MacGregor 150 MT Knuckle Boom Jib Crane SWL-25 mt @ 35 m / 75 mt @ 20 m / 100 mt @ 15 m / 150 mt @ 10 m (1.4 dynamic) 150 mt single line lift; 3,000 m operational depth

ACCOMMODATIONS

Accommodations	62 Bunks - (26 x 2 Person), (2 x 4 Person), (2 x 1 Person) & (1 Conference Room)
----------------	---

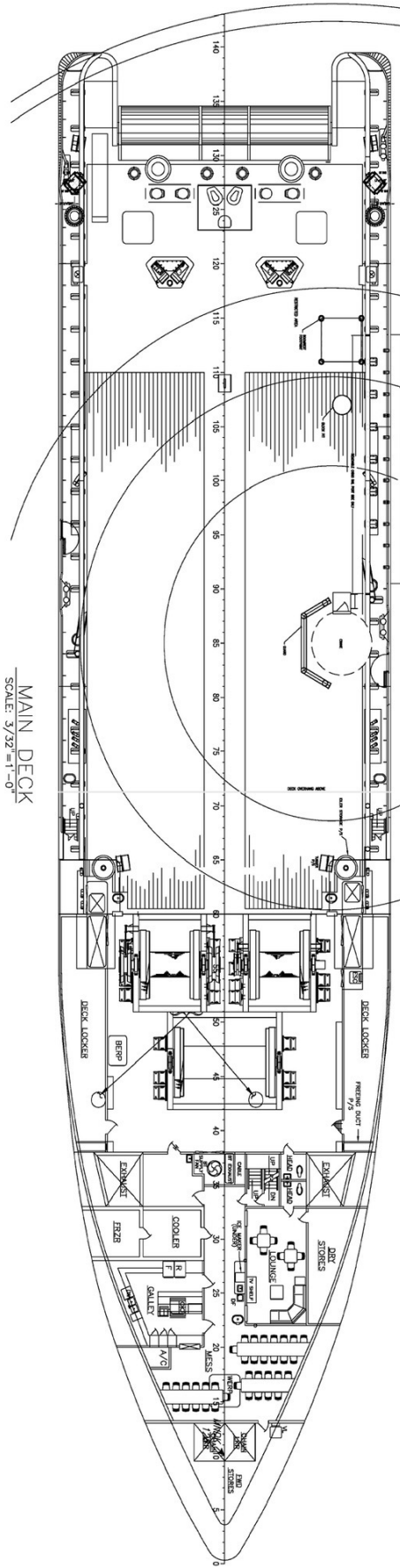

MAIN DECK
SCALE: 3/32"=1'-0"

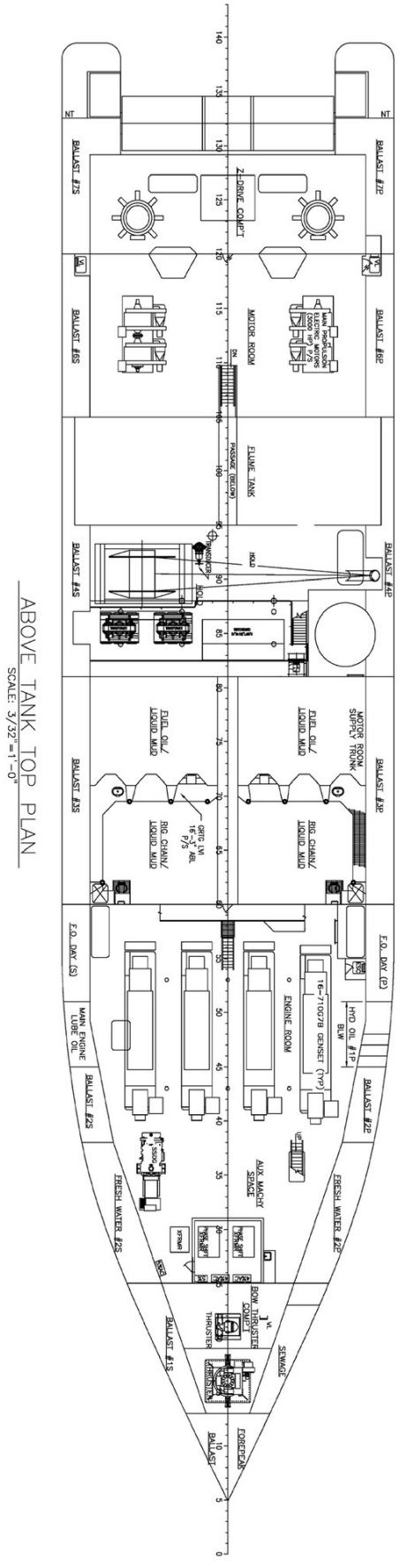

ABOVE TANK TOP PLAN
SCALE: 3/32"=1'-0"

