

# Technical Specifications

## LEG

Leg Length	200 ft
Leg Diameter (Od)	66 in
Leg Tower Height	15 ft

## HULL

Length (Overall)	105 ft
Length (Barge Only)	102 ft
Beam (Overall)	78 ft
Beam (Barge Only)	78 ft
Hull Depth	13 ft

## PAD

Length	26 ft
Width	14 ft
Depth	2 ft
Bearing Load	N/A
Design	4-Way Slope

## CRANE

	Port	Starboard
Load Rating	100 ton	25 ton
Make	Amclyde	Nautilus
Model	20000HD	180BT3-72
Boom Type	Lattice	Telescopic
Boom Length	100 ft	70 ft
Crane Inst. Type	Deck Mount	Deck Mount

## PROPULSION

Mains - Make	CAT
Mains - Model	3406
Horsepower	1,095 kw
Bow Thruster Equipped	No
Clutch Make/Reduction	N/A
Consumption/Engine-Full	22.6 gph
Consumption/Engine-Half	16.8 gph

## GENERATORS

Generator Engine Make	CAT
Generator Engine Model	3404
Generator Output	105 kw
Consumption/Gen	9.5 gph

## DECK

Total Deck Area	5,275 ft <sup>2</sup>
Clear Deck Area	2,688 ft <sup>2</sup>
Additional Clear Area	1,020
Maximum Deck Load	1,100,000

## CAPACITIES

Diesel Fuel	11,298 usg
Lube	250 usg
Hydraulic Oil	2,236 usg
Potable Water	17,126 usg
Watermaker Equipped	No

## ELECTRONIC AIDS & COMMUNICATION

Compass	Fully Equipped
Gps/Dgps	Fully Equipped
Radar(s)	Fully Equipped
Fathometer	Fully Equipped
Loudhailer	Fully Equipped
Satellite Phone	Fully Equipped
VHF Radio	Fully Equipped
Single Sideband Radio	Fully Equipped
EPIRB	Fully Equipped
GMDSS	Fully Equipped

## PERSONNEL ACCOMMODATIONS

Total Accommodations	41
VIP Accommodations	2
Galley & Dining	Fully Equipped
TV Lounge	Fully Equipped
Laundry Facility	Fully Equipped
Air Condition / Heater	Std Central Units

## PERFORMANCE

Estimated Speed	4 knots
Max Sep – Pad to Deck	195 ft
Max Working Water Depth	160 ft
Min Working Water Depth	12 ft

## DOCUMENTATION

Class	None
Flag/ Port of Registry	USA
USCG	Inspected
SOLAS	No

Year Built 1998

Zero Discharge	Yes
Registered Tonnage	None
International Tonnage	859

## AMCLYDE 100 TON CRANE

### 20000HD 100 FT LATTICE BOOM MAXIMUM SAFE WORKING LOAD

BOOM RADIUS (ft)	ONBOARD LOAD (lbs.)	OFFBOARD LOAD (lbs.)
25	200,000	133,000
30	200,000	127,000
35	165,000	108,000
40	142,000	93,000
45	125,000	81,000
50	110,000	72,000
55	99,000	64,000
60	90,000	58,000
65	82,000	53,000
70	76,000	48,000
75	70,000	45,000
80	65,000	41,000
85	60,000	38,000
90	57,000	36,000
95	53,000	33,000
100	50,000	31,000
105	47,000	29,000
106	46,000	29,000

FAST LINE RATED FOR 12,000 AT ALL RADII

## NAUTILUS 25 TON CRANE

### 180BT3-72 70 FT TELESCOPIC BOOM MAXIMUM SAFE WORKING LOAD

#### 29 FT BOOM RETRACTED

BOOM RADIUS (ft)	ONBOARD LOAD (lbs.)	OFFBOARD LOAD (lbs.)
5	43,200	28,467
10	43,200	28,467
15	43,200	28,467
20	43,200	28,467
25	43,200	28,467
29	43,200	28,467

#### 72 FT BOOM EXTENDED

BOOM RADIUS (ft)	ONBOARD LOAD (lbs.)	OFFBOARD LOAD (lbs.)
10	16,100	10,400
15	16,100	10,400
20	16,100	10,400
25	16,100	10,400
30	16,100	10,400
35	16,100	10,400
40	16,100	10,400
45	16,100	10,400
50	16,100	10,400
55	15,719	10,146
60	14,161	9,107
65	12,826	8,217
70	11,683	7,455
72	11,247	7,165

FAST LINE RATED FOR 6,483 AT ALL RADII

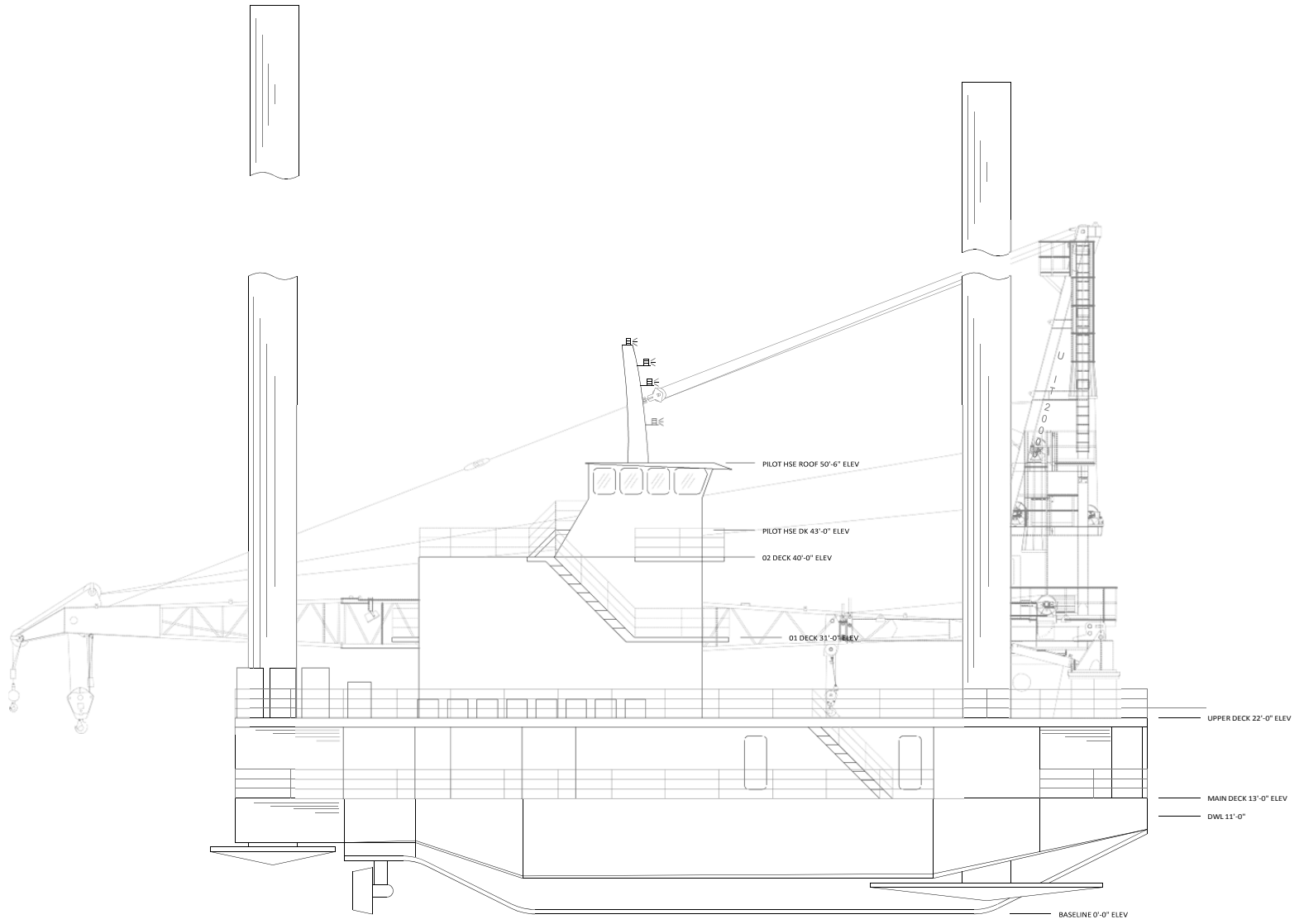

# Open Deck Area

Total Deck Area  
5,275 Square Feet

Clear Deck Area  
2,688 Square Feet

Additional Clear Area  
1,020 Square Feet

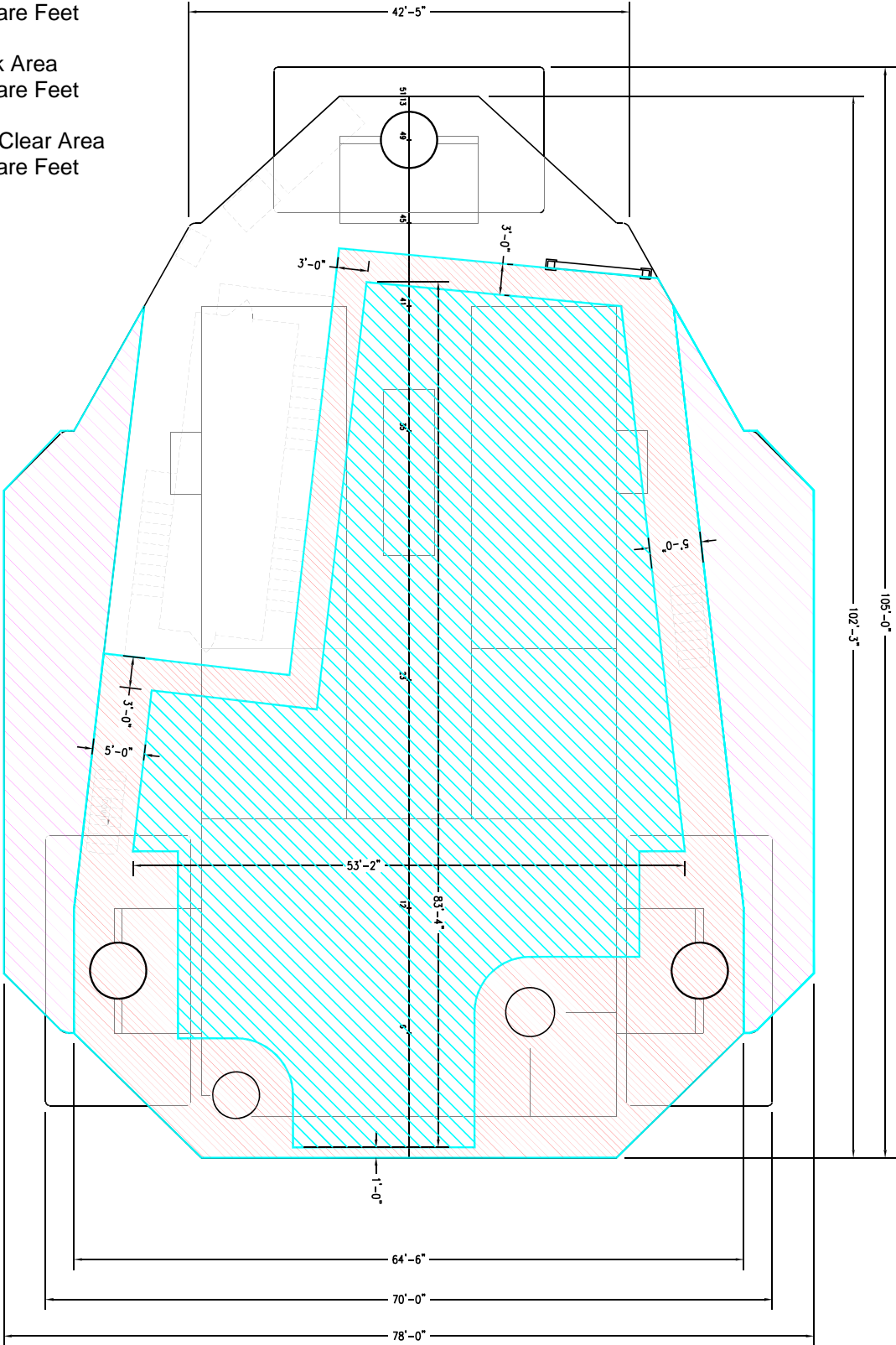

## Main Deck Quarters

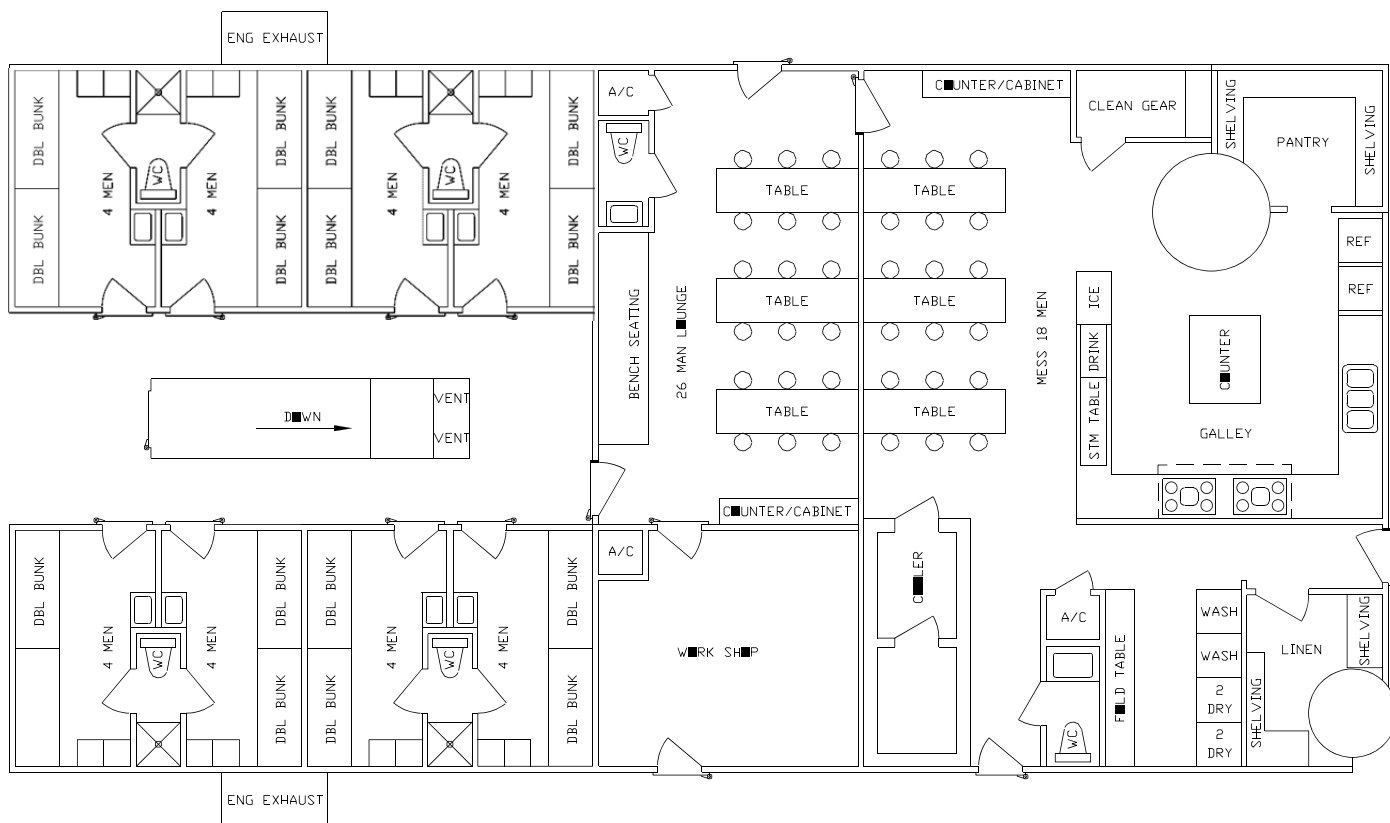

## 01 Level Quarters

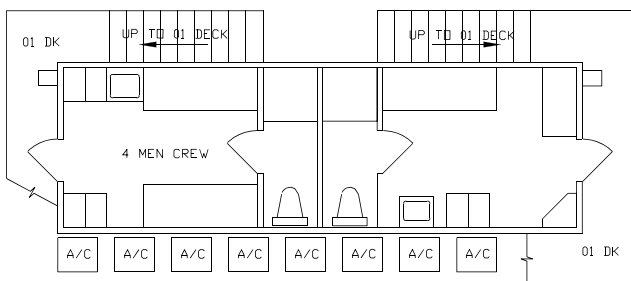

## Pilothouse Level

