

67M / BP 96T / DP2 OFFSHORE SUPPORT VESSEL

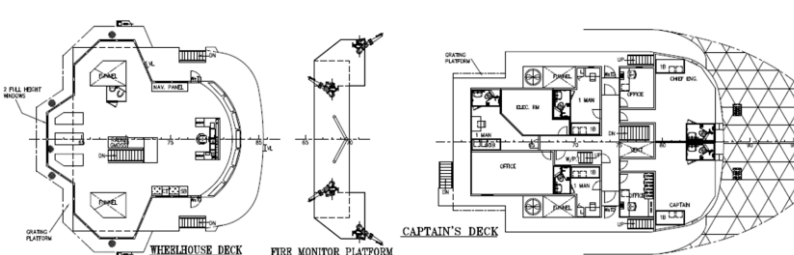
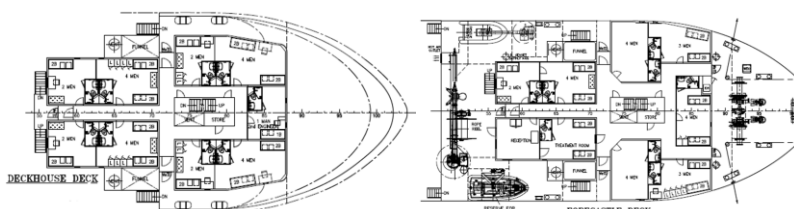
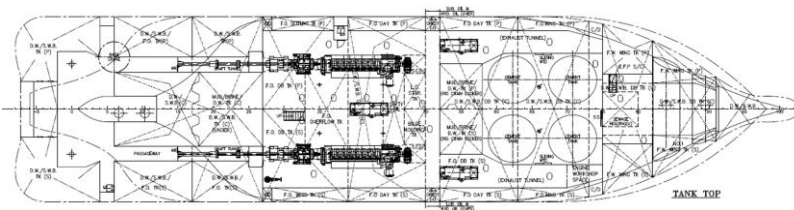
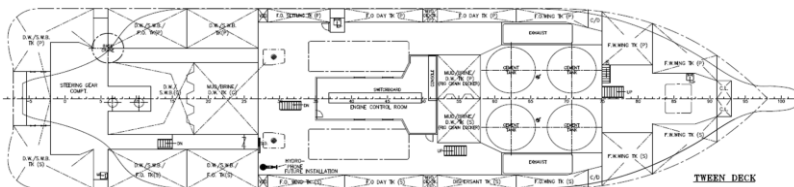
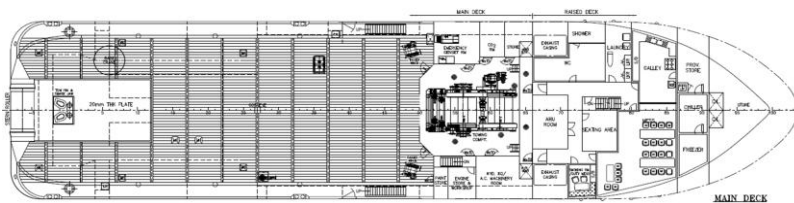

The vessel is designed and built as an offshore support vessel, which has twin screw with controllable pitch propeller, two (2) bow/ two (2) stern tunnel thrusters and two (2) station controls in wheelhouse. Two main diesel engines with 2×2666 kw totally.

Bollard pull is no less than 96t at 100% MCR. Performance speed is no less than 13 knots at 100% MCR. It is classed to DNV and satisfy external FI-FI II Class & Dynamic Positioning II requirement.

It can transport liquid cargo, bulk cement, liquid mud, stores, materials & equipment, also can perform towing & anchor handling duties. It can be a salvage vessel and she can conduct a service for seabed oilfield typically for production platforms or supporting offshore drilling campaigns. Vessel is equipped with a wide range of devices for fire fighting, salvation etc..

This vessel has the advantages of large power, good sea-keeping performance, excellent maneuverability with advanced equipment. Its technology is built with the highest quality from vendors across the world.

67M / BP 96T / DP2 OFFSHORE SUPPORT VESSEL

PRINCIPAL PARTICULARS

Length overall:67.20m.
Length between pp:58.90m.
Breadth moulded :16.00m.
Depth moulded :6.50 m.
Design draft:5.00m.
Scantling draft:5.10m.
Bollard pull:Min. 96t with main at 100%MCR.

REGISTRATION

Flag:Liberia
Classification: ...DNV Maltess Cross+1A1 Offshore Service Vessel, SPS, Clean, DYNPOS-AUTR, E0, Fi-Fi II COMF-V(rating3), TMON, Recycle, BIS for unrestricted service.
Regulation:SOLAS, Marpol, IMO A 469 (XII).

PERFORMANCE SPEED

Min. 13 knots at 100% MCR

ENDURANCE

Min. 25 days

ACCOMMODATION

Captain's Deck	Deckhouse Deck	Forecastle Deck	Total
5x1MAN=5MEN	1x1MAN=1MAN	4x4MEN=16MEN	
	4x2MAN=8MAN	1x2MEN=2MEN	
	4x4MAN=16MAN	2x3MEN=6MEN	
5MEN	25MEN	24MEN	54MEN

PROPULSION – MACHINERY

Main diesel engines:2x2666KW
Shaft generators:2x1200KW, 440V/60Hz
Auxiliary generators:3x550KW, 440V/60Hz
Emergency generator:1x150KW, 440V/60Hz
Main propellers:2xCPP
Tunnel thrusters aft:2x500KW
Tunnel thruster forward:2x950KW
Rudders:2xoff high lift flap rudder

TOWING/MOORING WINCH

Anchor: 2xAC-14 high holding power anchors, each min. 1845 kg
Chain cables: 467.5M total length, 44mm dia. Grade 2 high strength stud link chains.
Mooring lines: 4x170m long mooring rope of minimum 186kN breaking strength
Towing wire: 1x190m @ 479kN breaking strength
Anchor Windlass:
Duty pull: 12.4t at 0 to 21m/min
Gypsy size: suitable for 44mm dia. U2 high strength stud line chain.
Chain stopper: suitable for 44mm dia. U2 high strength stud line chain.
Brake control: manual operated band brake
Gypsy clutch: manual operated jaw clutch
Mooring Storage Drum:
Drum capacity: 220m x 64mm P.P tope approx.
Duty Pull: 15.8t at 0 to 18 m/min (1st layer)
 : slack rope at 0 to 69 m/min
Brake control: manual operated band brake
Drum clutch: manual operated jaw clutch.
Mooring Bollards
Bollards: 10x10" NB sch 80 heavy pipe bollards
Mooring Posts/Closed Chocks: 6xmooring pipes & 3xclosed chocks, 300x400
Stand Roller: 6x250 mm dia. & 2x200mm dia. Fair lead-open type stand rooler
Towing Pins: 2x200 tonnes SWL
Shark jaws: 2x11/4" to 4" dia. Wire and chain. SWL 300t
Capstan: 2xvariable speed hydraulic capstan
Duty pull: 10 t @ 0 to 18 m/min
 : lightline speed @ 0 to 19 m/min
Tugger Winch: 2xvariable speed hydraulic Tugger
Duty pull: 10 t pull @ 0 to 24 m/min
 : 3 t pull @ 0 to 75 m/min
 : lightline speed @ 0 to 97 m/min
Storage Rope Reel: 1xvariable speed storage rope reel
Duty pull: 7 t @ 0 to 75 m/min
 : lightline speed @ 0 to 127 m/min
Electric-Hydraulic power pack for Deck Machinery: 3xelectric hydraulic power pack

CAPACITIES & PUMPS

FW/DW/SWB tank:700M³ approx.
FW tank:420 M³ approx.
F. O. tank:590 M³ approx.Pump2x20 M³/h
F. O. overflow tank:18 M³ approx.
Cement tank:215 M³ approx.
Liquid mud/Brine DW tank: ...350 M³ approx.Pump2x100 M³/h
Brine/DW/SWB tank(or rig chain locker):...150 M³ approx.
Lub oil:12 M³ approx.
Dispersant tank:15 M³ approx.
Sewage holding tank:16 M³ approx. Pump1x15 M³/h
Bilge holding tank:7 M³ approx.
Dirty oil tank:8 M³ approx.
Hydraulic oil tank:7.5 M³ approx.

ELECTRONICS

2xradar 96NM X-band
3xgyrocompass system with repeaters
1xecho sounder
1xspeed log
1xGPS
2xDGPS
1xradio system compliant with GMDSS A3 rules
DP SYSTEM (class II)
ERN NUMBER:99,99,96,96
SPECIAL EQUIPMENT:
FIFI II : 2x3700 M³/h
Liferafts: 4x25men & 4x20 men inflatable liferafts
Rescue/Workboat: 1xsemi rigid type rescue boat
 1x40HP long shaft motor capable of carrying 6 persons
 & 1x1.65t SWL remote operated davit for lifting and launching
Cranes: 1xelectro-hydraulic & luffing deck crane, 3t. at 10m radius
DECK
 Deck Area: 435 m²